

AS
MOTOR

2021



GENERAL CATALOGUE EN INT

Valid from 01/10/2020



ALL TERRAIN MOWERS
MADE IN GERMANY

www.as-motor.com

ENGINEERED MOWING SOLUTIONS

Back in the 1950s, our founder and namesake Alfred Schefenacker (AS) was an inventor living in Southern Germany. During his daily walks outside Stuttgart he noticed how difficult it was to mow between the steep and narrow rows of the local vineyards. Besides being steep, vineyards were only mowed perhaps once per year and the prunings left thick vines along the way. There seemed to be no solution to this tough mowing job, so Schefenacker decided to invent one.

Knowing the engine is the heart of every machine, Alfred built his own custom two-stroke engine to power the first Allmäher® (all-mower) up slopes. Robust, agile, and specifically engineered for rough-terrain, the AS-Motor Allmäher® was a major innovation, significantly improving an otherwise onerous task.

AS-Motor would remain a major innovating force in the years to come, and today remains one of the most trusted manufacturers of professional-grade mowers in Europe and around the world for municipalities, landscapers, groundskeeping, contractors and private users. Its history of engineering milestones translates to a culture of innovation that keeps AS-Motor on the cutting edge of the industry. AS-Motor continues to engineer all its machines in-house, from a 12-person strong Research & Design team all the way to testing, components, manufacture and final assembly.

Driving around Southern Germany today, one can still see farmers using the Allmäher® they bought 30 years ago. Some miles down the road at AS-Motor's headquarters in Bühlertann, the Allmäher's original design is still being manufactured by a socially and environmentally responsible company, confirming Alfred Schefenacker's founding philosophy from way back in 1959 – robust machines built to last, and a vision for the future.

»Each day, together with our motivated team we endeavour to bring you machines of the highest quality and sustainability.«

M. Lange E. Lange

Maria und Eberhard Lange,
CEO and grandchildren of the founder of the company

AS-MOTOR PRODUCT LINE

AS Mulching Lawn Mowers

Mulching mowers — the time-saving alternative! Today's grass will be tomorrow's fertiliser. AS mulching mowers don't just cut the grass finely; they also spray it out and chop it up at the same time. It can rot quickly, with valuable nutrients returned as an almost "invisible" fertiliser back into the lawn. No more collecting and cost intensive disposal.



| | Page |
|-----------------------------|------|
| AS 420 ProClip 4T | 19 |
| AS 470 ProClip 4T | 19 |
| AS 510 ProClip 4T A | 18 |
| AS 510 ProClip 2T ES A | 18 |
| AS 510 ProClip 4T A 2in1 | 18 |
| AS 510 ProClip 2T ES A 2in1 | 18 |
| AS 420 E-ProClip | 21 |
| AS 470 E-ProClip A | 21 |
| AS 510 E-ProClip A 2in1 | 20 |

AS Professional Lawn Mowers

Do you love a beautiful, green lawn? There are all sorts of lawns: steep or flat, with short or long grass, and uneven terrain, which all make a difference. AS-Motor has a mower convenient for every type of lawn. There are even models with all-wheel drive, reverse gear and brake.



| | Page |
|--------------------|------|
| AS 531 4T MK | 24 |
| AS 531 4T MK B | 24 |
| AS 531 2T ES MK B | 24 |
| AS 53 2T ES 4WD | 25 |
| AS 53 2T ES 4WD RB | 25 |

AS Allmäher®

Allmäher® — the superlative of high grass mowers. An Allmäher® is made for use in tough conditions, passing through difficult areas with extremely dense growth, slopes and rough terrain whilst still manoeuvring effortlessly around obstacles and trees.



| | Page |
|------------------|------|
| AS 21 4T B&S | 29 |
| AS 21 4T Comfort | 29 |
| AS 21 2T ES | 29 |
| AS 26 2T ES | 29 |
| AS 28 2T ES | 28 |
| AS 62 4T B&S | 33 |
| AS 63 4T Honda | 31 |
| AS 63 4T B&S | 31 |
| AS 63 2T ES | 31 |
| AS 65 4T B&S | 35 |
| AS 65 2T ES | 35 |
| AS 73 4T B&S | 37 |

AS Flail Mowers

Tall grass with brush, steep slopes, large areas in unknown territory — these mowers can handle it. AS Flail Mowers avoid foreign objects on the ground, while chopping and distributing the cut grass and scrub perfectly. This results in high output and increased safety.



| | Page |
|-----------|------|
| AS 701 SM | 41 |
| AS 901 SM | 40 |

AS Rotary Mowers

AS Rotary Mowers cut high grass very close to the soil surface and place it in neat rows, as swaths. Collecting the cut grass is very simple and the hassle of raking is completely eliminated.



| | Page |
|-----------|------|
| AS 585 KM | 43 |
| AS 625 KM | 43 |

AS Implement Carrier and Attachments

Do you regularly use different tools while undertaking maintenance? Do you need to cut different heights of grass and sweep paths and public areas, quickly changing between each job? Manage all these tasks in an environmentally friendly way with the new AS600 Pro implement carrier. The AS 600 provides flexibility for the day-to-day work routine of the professional service provider.



| | Page |
|------------------------|------|
| AS 600 MultiPro | 46 |
| ESM cutter bar | 47 |
| LOSI cutter bar | 47 |
| Flail mower deck 68 cm | 47 |
| Sweeping brush 100 cm | 47 |

AS Ride-on Allmäher

Require something stronger? Then the robust and versatile AS Ride-on Allmäher is just the thing! Whether for large areas, scrub, undergrowth or grass heights of up to 1.50 m, our ride-on mowers can handle it. If the terrain is steep, you will be well-served by our all-wheel drive models. Select one of eleven models that is right for your personal or professional use.



| | Page |
|----------------------|------|
| AS 799 Rider | 50 |
| AS 800 FreeRider | 51 |
| AS 900 Enduro | 53 |
| AS 915 Sherpa 2WD | 55 |
| AS 920 Sherpa 2WD | 57 |
| AS 940 Sherpa 4WD | 57 |
| AS 940 Sherpa 4WD XL | 56 |
| AS 940 Sherpa 4WD RC | 58 |
| AS 1020 YAK 2WD | 61 |
| AS 1040 YAK 4WD | 61 |
| AS 1040 YAK 4WD XL | 60 |

AS Weed Removers

Prevent damage and remove weeds in a mechanical way. The AS WeedHex removes growing weeds on cobblestone surfaces and at kerbs quickly and efficiently.



| | Page |
|-------------------|------|
| AS 50 WeedHex | 64 |
| AS 30 WeedHex 140 | 66 |
| AS 30 WeedHex 160 | 66 |
| AS 30 E-WeedHex | 67 |

AS-MOTOR AREAS OF IMPLEMENTATION

| AS PRODUCTS | | Maximum work rate in m2/hour (VMax x working width) | Maximum grass / undergrowth height in cm |
|---|----------------------------------|---|---|
| MULCHING LAWN MOWERS | | | |
| NEW | AS 420 ProClip 4T | ca. 1.600 | 18 |
| | AS 420 E-ProClip | ca. 1.500 | 15 |
| NEW | AS 470 ProClip 4T | ca. 1.800 | 18 |
| | AS 470 E-ProClip A | 1.000 | 15 |
| NEW | AS 510 ProClip 4T A and 2in1 | 2.000 | 2040Mulching / side discharge |
| | AS 510 E-ProClip A 2in1 | 1.850 | 2030Mulching / side discharge |
| | AS 510 ProClip 2T ES A and 2in1 | 2.150 | 2050Mulching / side discharge |
| PROFESSIONAL LAWN MOWERS | | | |
| AS 53 2T ES 4WD and 4WD RB | | 2.500 | 40 |
| AS 531 4T MK and 4T MK B | | 2.100 | 30 |
| AS 531 2T ES MK B 3in1 | | 2.300 | 50 |
| ALLMÄHER® | | | |
| AS 21 4T B&S and Comfort | | 1.500 | 60 |
| AS 21 2T ES | | 1.200 | 80 |
| AS 26 2T ES | | 1.500 | 80 |
| AS 28 2T ES | | 2.100 | 80 |
| AS 62 4T B&S | | 2.300 | 90 |
| AS 63 4T Honda and B&S | | 2.300 | 80(B&S 90) |
| AS 63 2T ES | | 2.400 | 100 |
| AS 65 2T ES | | 2.600 | 120 |
| AS 65 4T B&S | | 3.300 | 150 |
| AS 73 4T B&S | | 3.700 | 150 |
| FLAIL MOWERS | | | |
| AS 701 SM | | 2.500 | 100 |
| AS 901 SM | | 3.600 | 130 |
| ROTARY MOWERS | | | |
| AS 585 KM | | 1.450 | 80 |
| AS 625 KM | | 1.650 | 80 |
| IMPLEMENT CARRIER AND ATTACHMENTS AS 600 MultiPro | | | |
| NEW | with ESM professional cutter bar | 6.000 | 120 |
| | with LOSI cutter bar | 4.700 | 100 |
| | with flail mower deck | 3.600 | 80 |
| | with weed brush | 5.000 | |
| RIDE-ON ALLMÄHER | | | |
| AS 799 Rider | | 6.400 | 60 |
| AS 800 Freerider | | 6.400 | 80 |
| AS 900 Enduro | | 9.000 | 120 |
| AS 915 Sherpa 2WD | | 9.450 | 130 |
| AS 920 Sherpa 2WD | | 9.450 | 150 |
| AS 940 Sherpa 4WD | | 5.500 | 150 |
| AS 940 Sherpa 4WD XL and RC | | 6.000 | 150 |
| NEW | AS 1020 YAK 2WD | 6.800 | 150 |
| | AS 1040 YAK 4WD | 6.800 | 150 |
| NEW | AS 1040 YAK 4WD XL | 7.300 | 150 |
| WEED REMOVERS | | | |
| AS 50 WeedHex | | approx. 800 m edge cleaning or 400 m2 surface cleaning per brush pair | |
| AS 30 WeedHex | | approx. 10 hours brush life at high load (plate brush steel) | |
| AS 30 E-WeedHex | | approx. 10 hours brush life at high load (plate brush steel) | |

| AS PRODUCTS | | Gradient suitability Level > rising > very steep | Professional use | Mowing deck/functioning | Drive |
|---|--|---|---------------------|--|------------------------------|
| MULCHING LAWN MOWERS | | | | | |
| AS 420 ProClip 4T | | | | Mulching | — |
| AS 420 E-ProClip | | | | Mulching | — |
| AS 470 ProClip 4T | | | | Mulching | — |
| AS 470 E-ProClip A | | | | Mulching | One gear, rear wheel drive |
| AS 510 ProClip 4T A and (2in1) | | | | Mulching or (side discharge) | Rear wheel drive Vario |
| AS 510 E-ProClip A 2in1 | | | | Mulching or (side discharge) | Rear wheel drive Vario |
| AS 510 ProClip 2T ES A and (2in1) | | | | Mulching or (side discharge) | Rear wheel drive Vario |
| PROFESSIONAL LAWN MOWERS | | | | | |
| AS 53 2T ES 4WD and 4WD RB | | | | Side discharge | All-wheel drive Vario |
| AS 531 4T MK and 4T MK B | | | | Mulching, collecting or rear discharge | Rear wheel drive Vario |
| AS 531 2T ES MK B 3in1 | | | | Mulching, collecting or rear discharge | Rear wheel drive Vario |
| ALLMÄHER® | | | | | |
| AS 21 4T B&S and Comfort | | | | Mowing with side discharge | Rear wheel drive |
| AS 21 2T ES | | | | Mulching with side discharge | Rear wheel drive |
| AS 26 2T ES | | | | Mulching with side discharge | Rear wheel drive |
| AS 28 2T ES | | | | Mulching with side discharge | Rear wheel drive 2-gears |
| AS 62 4T B&S | | | | Mulching with rear discharge | Rear wheel drive Vario |
| AS 63 4T Honda and B&S | | | | Mulching with rear discharge | Rear wheel drive Vario |
| AS 63 2T ES | | | | Mulching with rear discharge | Rear wheel drive Vario |
| AS 65 2T ES | | | | Mulching with rear discharge | Rear wheel drive 5-gears |
| AS 65 4T B&S | | | | Mulching with rear discharge | Rear wheel drive 5-gears |
| AS 73 4T B&S | | | | Mulching with rear discharge | Rear wheel drive 5-gears |
| FLAIL MOWERS | | | | | |
| AS 701 SM | | | | Mulching with flails | Rear wheel drive 5-gears |
| AS 901 SM | | | | Mulching with flails | Rear wheel drive 5-gears |
| ROTARY MOWERS | | | | | |
| AS 585 KM | | | | Rotary with side discharge | Rear wheel drive |
| AS 625 KM | | | | Rotary with side discharge | Rear wheel drive 2-gears |
| IMPLEMENT CARRIER AND ATTACHMENTS AS 600 MultiPro | | | | | |
| with ESM professional cutter bar | | | | Double knife cutting bar | Hydrostatic wheel drive |
| with LOSI cutter bar | | | | Double knife cutting bar | Hydrostatic wheel drive |
| with flail mower deck | | | | Mulching with flails | Hydrostatic wheel drive |
| with sweeping brush | | | | Nylon sweeping brush | Hydrostatic wheel drive |
| RIDE-ON ALLMÄHER | | | | | |
| AS 799 Rider | | | | Mowing with rear discharge | Rear wheel drive hydrostatic |
| AS 800 Freerider | | | | Mulching with rear discharge | Rear wheel drive hydrostatic |
| AS 900 Enduro | | | | Mowing with side discharge | Rear wheel drive hydrostatic |
| AS 915 Sherpa 2WD | | | | Mulching with rear discharge | Rear wheel drive hydrostatic |
| AS 920 Sherpa 2WD | | | | Mulching with rear discharge | Rear wheel drive hydrostatic |
| AS 940 Sherpa 4WD | | | | Mulching with rear discharge | All-wheel drive hydrostatic |
| AS 940 Sherpa 4WD XL and RC | | | | Mulching with rear discharge | All-wheel drive hydrostatic |
| AS 1020 YAK 2WD | | | | Mulching with flails | Rear wheel drive hydrostatic |
| AS 1040 YAK 4WD | | | | Mulching with flails | All-wheel drive hydrostatic |
| AS 1040 YAK 4WD XL | | | | Mulching with flails | All-wheel drive hydrostatic |
| WEED REMOVERS | | | | | |
| AS 50 WeedHex | | | | | Rear wheel drive Vario |
| AS 30 WeedHex | | | 140 | | — |
| AS 30 E-WeedHex | | | | | — |

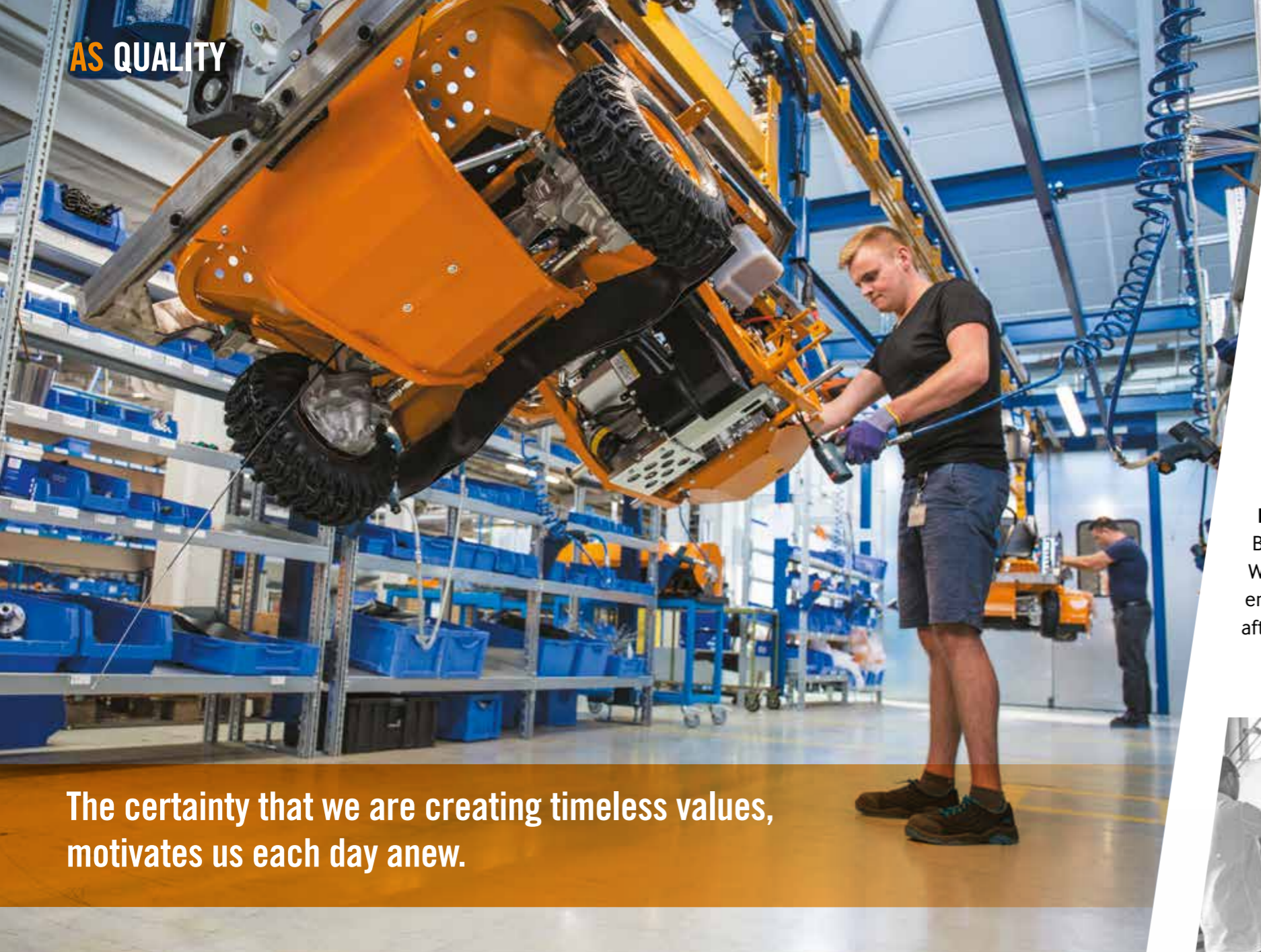

The certainty that we are creating timeless values, motivates us each day anew.

MADE IN GERMANY

AS-Motor is committed to vertical integration depth; we develop and produce almost all of our components in our own manufacturing facilities in Germany. This is the only way to ensure quality and reliability – “Made in Germany” as we understand it.

Design and development

We implement our own ideas and meet the current market requirements, from CAD-assisted new developments to prototype construction and this we always do in compliance with the most rigorous quality standards.

The highest level of quality

The engine devices and 2-stroke engines developed in-house are reliably and accurately assembled by trained specialists. Every hand grip is perfectly seated to the last detail. Our assembly employees know “their products” like the back of their hand. In addition, every device runs through a final test.

Intensive practical test

Before the start of series production, our devices are subject to extensive practical tests. We sell our products exclusively via trained specialised dealers. This is the only way to ensure that you are ideally supported and that original spare parts will still be available after the production series of a device is discontinued.

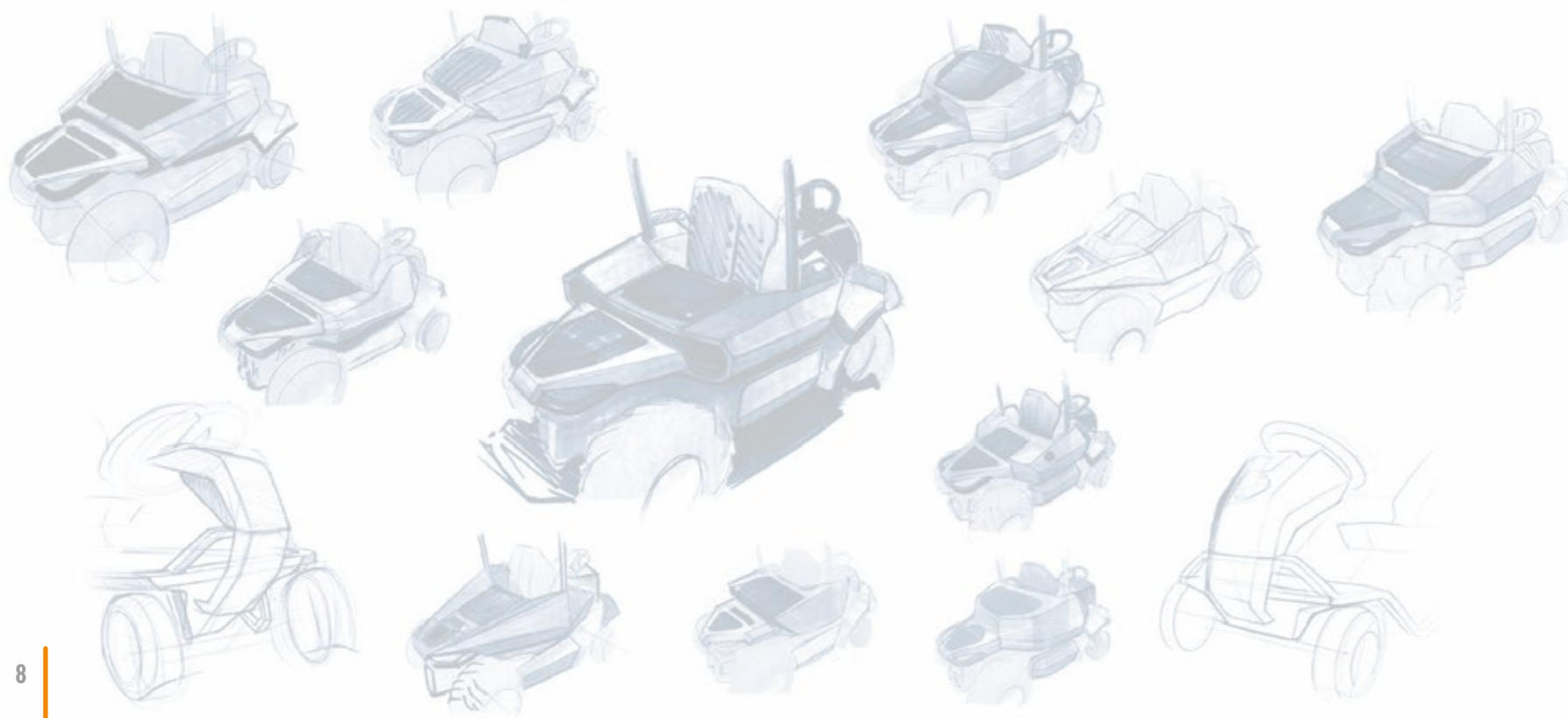
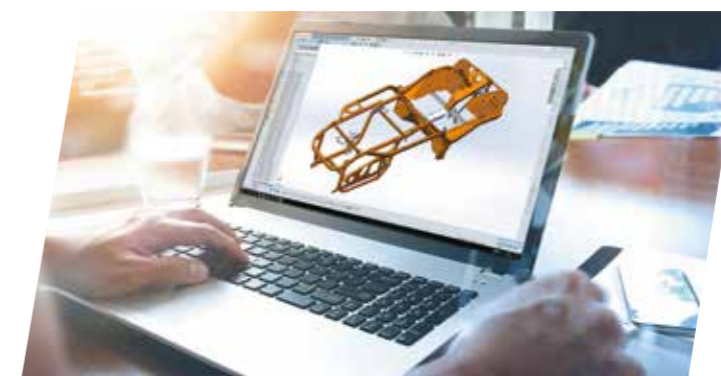

LET IT BLOOM – MOW LATER & MOW BETTER

At a time of increasingly intensive land use grassland, meadow orchards, field margins, waysides, meadows on slopes and roadside greenery are the only extensively used areas. They constitute valuable habitat and retreats for a variety of plant and animal species. Now mankind doesn't automatically have to be the destroyer of diversity. Historically it was farmers and countrymen, who through their activity in Central Europe over thousands of years created a diverse, structured, landscape with innumerable habitats for a wide variety of species.

Ecologically oriented grassland care – not mowing is not a solution!

Fallow land encourages biodiversity, no mowing or intervention has a positive effect on the fauna. On the other hand, this is not a viable option for the plant kingdom; without intervention vegetation changes, plants worth protecting lose their habitat and biotopes disappear. If grass areas are left to themselves without intervention, this first results in creeping scrub encroachment, which ultimately becomes a plant community dominated by woody plants and diminished biodiversity. But if neither mowing, or not mowing provides meaningful results, what can you do? As is so often the case, you end up with compromise solution.

Principles of meaningful, extensive grassland care should be :

- As little intervention in the area as possible but as much as necessary, focus on biodiversity
- Use all possibilities of animal-friendly meadow management
- Maintain a proportionality between nature conservation, profitability and occupational health and safety

As the high-grass-mower specialist #1, AS-Motor offers different mowing systems. Sickle mowers, sickle mulchers, flail mowers, rotary mowers and cutter bar mowers. Now it is up to you to use these mowers in an effective combination!

For detailed information
about **ecologically oriented**
green space maintenance:



Keeping clear of
species-rich
dry grasslands



Gentle cut with
double blade-
cutter bar



Creeping scrub
encroachment



Extensive care of
orchard meadows



Keeping marginal areas open



Pulsatilla vulgaris in dry
grassland, Bavaria



ENGINES DESIGNED SPECIFICALLY FOR OUR MOWERS

Since 1959 AS-Motor has designed and produced engines specifically matched to the use of our mowers and the respective area of implementation. In this regard, quality, performance and efficiency are always the top priorities. Consequently, we also make no compromises for the components installed in the engines, relying on our in-house developments with a vertical integration depth of over 90 %.

The two-stroke engine that we have developed is a powerhouse. It works with high torque and incredible power at favourable consumption values. AS-Motor is the world's only manufacturer to build 2-stroke engines for mowers that meet the requirements stipulated in the European Emissions Standard (EU) 2016/1628 (stage V).

Unlike 4-stroke engines, the 2-stroke engine has no restrictions whatsoever for use on a slope. Inclines of 45° and more are possible. The use limit is only set by the work safety of the user.

Our engineers work constantly on further perfecting the engines. The latest milestone of this development is the innovative 'EasyStart' system for considerably improved convenience when starting. Thus the AS 2-stroke engine remains the leader of its class.

- + **EasyStart** reduces the pull force on the starter rope by 60% and at half the pull distance
- + The digital ignition system (CDI) reduces the necessary start rpm by 50%
- + Optimised air-fuel channels in the engine and carburettor
- + Minimal fuel consumption, reduced noise emissions and reduced heat development

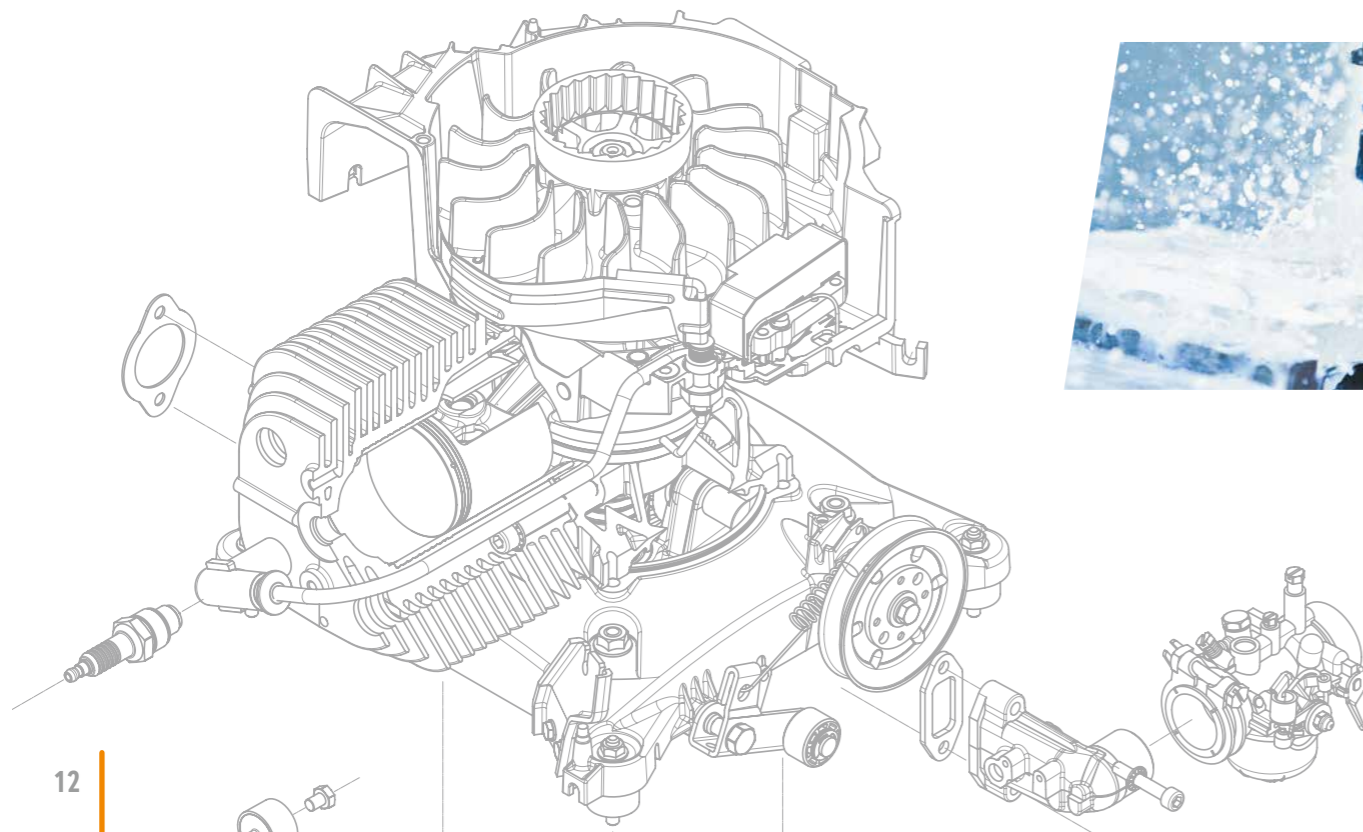

CNC-milling



Final inspection – precision crankshaft



Manufacturing of AS 2-stroke engine



AS MULCHING LAWN MOWERS



CUSTOMERS SWEAR BY OUR MULCH MOWERS

A beautiful lawn is not only nice aesthetically, but also beneficial for preventing growth of unwanted weeds. But this splendor, which every homeowner wishes for, must be well prepared. Particularly by careful mulching, in which the cuttings remain on the lawn.

It is especially important that the clippings are very finely crushed and then evenly distributed. The nitrogen contained in the cuttings is mineralised very quickly and remains available as a nutrient so the grass and plants that grow back. Mulching is a prime example of sustainability.

The AS mulching mowers allow time-saving care of your lawn. The grass is cut and remains in place. No multiple engine start, no grass collection bag, no disposal of the cuttings.

How it works: when mulching, the grass is first cut several times and then whirled like in a fan to the top, only to be pushed in the same process immediately down to the bottom. The cut grass is so finely shredded that it simply disappears between the stems left standing and then quickly rots and turns into fertiliser.

Advantages of AS-Motor Mulching Mowers: high stability of the mulching bell, triple crankshaft bearing, mulching blade of spring steel, lightweight and yet stable front wheels. Longer grass (for instance when you come back home from holiday) can be mulched with AS Mulching Mowers with the same result.

As for performance, there is a solution to meet any challenge. AS Mulching Mowers are available with or without wheel drive, engine power up to 6 hp, cutting widths of 42, 47 or 51 cm with a cutting height range of 30 – 90 mm. Very importantly for users: through the spring-assisted central height adjustment, the mower can be adjusted in seconds to the desired cutting height.

IN FOCUS: THE NEW AS MULCHING LAWNMOWERS WITH LI-ION BATTERY



Three models of our mulching lawnmowers are now available with B&S 82 V battery technology. Working with these mowers is a genuine relief – less vibration, less noise, lower weight, and no exhaust emissions.

By the way: on a lawn size of about 1000m² up to 2 tons of cuttings can accumulate per year. Not everyone has a green recycling bin, and proper disposal can be expensive. Mulching saves you time and money – lawn care made easy.



MULCHING OFFERS MANY ADVANTAGES

- Cutting, maintaining and fertilising in one work step
- No collection bag, no disposal of the cuttings
- Improves the quality of your lawn
- Protects the lawn from drying out
- Up to 30 % time savings

PERFECT MULCHING

When mowing, the cuttings are cut several times in the mulching unit and are finely distributed.

MOW WITHOUT COLLECTION BAG

No stopping, no emptying and no disposal of the cuttings is required.

ROBUST CONSTRUCTION

Durable, crankshaft with 3rd bearing support. Galvanised steel mulching deck with reinforced edge. Tubular steel frame with folding handlebar.

EASY MANOEUVRING

Lightweight, stable front wheels guarantee greater maneuverability

CENTRAL HEIGHT ADJUSTMENT

Easy 5x or 6x height adjustment of the mower deck per lock lever from 30 to 90 mm. Quick adjust spring loaded height of cut lever.

Watch our videos on
YouTube

> STEP 2:

The air flow generated by the mulching blade uniformly whirled up the cuttings in the mulching deck.

> STEP 3:

The grass is uniformly whirled up, then chopped several times by the mulching blade with multiple cutting edges.

> STEP 1:

The spring steel mulching blade cleanly cuts off tall grass up to a height of max. 20 cm.

> STEP 4:

The cuttings sink into the turf where they are virtually invisible. Important nutrients and moisture are returned to the lawn. The layer of mulch produced in this manner protects the lawn from drying out quickly.



Even in dense and wet grass AS-Motor mulching lawn mowers offer an astonishing cutting finish. This is achieved by using a deep mulching deck, with strong airflow and the especially high designed blade with three individual cutting edges.



Additional benefit: dry leaves in autumn are perfectly mulched up as well.

AS 510 ProClip

Cutting and chopping grass while returning it to the lawn as fertilizer – with the AS 510 you can even cut medium height grass in a timesaving manner. The special spring steel blade inside the stable mulching bell splits the grass so thinly that time-consuming grass collection is no longer necessary. Thanks to its perfectly balanced, stable and agile design, you can mow effortlessly and improve the quality of your lawn.

Now available as the 2in1 version for mowing higher lawn and grass up to 50cm high.

Tip: don't be fooled by the rated power specifications. The models with AS 2-stroke engine are of more power and torque than the 4-stroke models (see max. grass height page 6).



Infinitely variable speed (Variomatic)

5 litre fuel tank

Stable double frame

Strong, profiled rear wheels provide excellent traction

2in1
2in1 models are factory-equipped with easy to mount mulch plate and side discharge deflector for cutting grass heights up to 50 cm

AS 510 ProClip 2T ES A 2in1

AS 2-stroke engine with EasyStart reduces forces on the starter rope by 60% at half the pull distance



Solid steel mulching bell
Third crankshaft bearing



TECHNICAL SPECIFICATIONS

Accessories overview see page 68

| Model | Cutting width | Engine | Rated power | Maximum engine power | Wheel drive, speed | Cutting height adjustment | Weight, dimensions | Item number |
|-----------------------------|---------------|--|--|--|--|----------------------------|--|-------------|
| AS 510 ProClip 2T ES A 2in1 | 51 cm | AS 2-stroke, ES 165 ccm | 2,8 kW (3,8 hp) at 2.800 min ⁻¹ | 4,4 kW (6,0 hp) at 4.500 min ⁻¹ | Variomatic 2,1–4,3 km/h Rear wheel drive | central (30) 40–90 mm, 6 x | 48 kg L 139 cm, W 55 cm, (W 73 cm), H 100 cm | G51000110 |
| AS 510 ProClip 4T A 2in1 | 51 cm | B&S 4-stroke, 850E-Series I/C, 190 ccm | 3,2 kW (4,3 hp) at 2.800 min ⁻¹ | 4,1 kW (5,5 hp) at 3.600 min ⁻¹ | Variomatic 2,0–4,3 km/h Rear wheel drive | central (30) 40–90 mm, 6 x | 44 kg L 139 cm, W 55 cm, (W 73 cm), H 100 cm | G51000109 |
| AS 510 ProClip 2T ES A | 51 cm | AS 2-stroke, ES 165 ccm | 2,8 kW (3,8 hp) at 2.800 min ⁻¹ | 4,4 kW (6,0 hp) at 4.500 min ⁻¹ | Variomatic 2,1–4,3 km/h Rear wheel drive | central (30) 40–90 mm, 6 x | 48 kg L 139 cm, W 55 cm, H 100 cm | G51000111 |
| AS 510 ProClip 4T A | 51 cm | B&S 4-stroke, 850E-Series I/C, 190 ccm | 3,2 kW (4,3 hp) at 2.800 min ⁻¹ | 4,1 kW (5,5 hp) at 3.600 min ⁻¹ | Variomatic 2,0–4,3 km/h Rear wheel drive | central (30) 40–90 mm, 6 x | 43 kg L 139 cm, W 55 cm, H 100 cm | G51000108 |



HANDLEBAR HEIGHT

Simple, stable handlebar height adjustment (AS 510 ProClip).



SLIM FRONT WHEELS

Narrow yet stable front wheels with 2 ball bearings minimise grass compaction.



3rd CRANKSHAFT BEARING

Crankshaft with additional 3rd ball-bearing and friction clutch on blade for maximum engine protection against blade impacts. Galvanised one-piece steel mulching deck (all models).



CENTRAL HEIGHT ADJUSTMENT

Easy-to-operate, central, spring-supported height of cut adjustment. Min. cutting height 30 mm possible by slight modification (all models).



Watch our videos on YouTube

TECHNICAL SPECIFICATIONS

Accessories overview see page 68

| Model | Cutting width | Engine | Rated power | Maximum engine power | Wheel drive, speed | Cutting height adjustment | Weight, dimensions | Item number |
|-------------------|---------------|--|--|--|--------------------|----------------------------|-----------------------------------|-------------|
| AS 420 ProClip 4T | 42 cm | B&S 4-stroke, 850E-Series I/C, 190 ccm | 3,2 kW (4,3 hp) at 2.800 min ⁻¹ | 4,2 kW (5,7 hp) at 3.600 min ⁻¹ | — | central (30) 40–80 mm, 5 x | 30 kg L 127 cm, W 46 cm, H 100 cm | G47000204 |
| AS 470 ProClip 4T | 47 cm | B&S 4-stroke, 850E-Series I/C, 190 ccm | 3,2 kW (4,3 hp) at 2.800 min ⁻¹ | 4,2 kW (5,7 hp) at 3.600 min ⁻¹ | — | central (30) 40–80 mm, 5 x | 31 kg L 131 cm, W 51 cm, H 100 cm | G47000103 |

AS 510 E-ProClip A 2in1 **NEW**

100% power, zero emissions. That's the future of professional lawn care: Modern lithium-ion battery technology combined with robust and reliable mechanics.

Robust steel construction, top cut and perfect mulching result.

The new AS-Motor mulching mowers with lithium-ion battery are on the same level in terms of power as the models with internal combustion engine.

The clean answer to environmental pollution from combustion gases, especially in urban areas.



B&S 82V MAX lithium ion powerhead, 1,35 kW with automatic power and engine speed adjustment, li-ion battery 5.0 Ah

Stable double frame

Infinitely variable speed (Variomatic)

Strong, profiled rear wheels provide excellent traction

Robust, mechanical rear wheel drive

Motorshaft with additional 3rd ball-bearing and friction clutch on blade

Solid steel mulching bell

2in1

2in1 models are factory-equipped with easy to mount mulch plate and side discharge deflector for cutting grass heights up to 40 cm



TECHNICAL SPECIFICATIONS

Accessories overview see page 68

| Model | Cutting width | Engine | Rated Voltage | Max. Voltage | Wheel drive, speed | Cutting height adjustment | Weight, dimensions | Item number |
|-------------------------|---------------|---|---------------|--------------|--|--------------------------------|--|---------------------------------------|
| AS 510 E-ProClip A 2in1 | 51 cm | B&S 82Li Series 82V Lithium Ion Powerhead | 72 Volt | 82 Volt | Variomatic 2,0–4,0 km/h Rear wheel drive | central (30) 40–(80) 90 mm 6 x | 39 kg (without battery) L 139 cm, W 55 cm, (W 73 cm), H 100 cm | G51000112 without battery and charger |



B&S 82V MAX LITHIUM ION POWERHEAD

The intelligent engine control recognizes the power requirement and regulates the engine speed and power automatically.



3rd MOTORSHAFT BEARING

Motorshaft with additional 3rd ball-bearing and friction clutch on blade for maximum engine protection against blade impacts. Galvanised one-piece steel mulching deck.



POWERFUL LI-ION BATTERY

B&S 82V Smart lithium ion battery for consistent performance. With integrated charge status indicator. (Not included).



CENTRAL HEIGHT ADJUSTMENT

Easy-to-operate, central, spring-supported height of cut adjustment. Min. cutting height 30 mm possible by slight modification.

AS 470 E-ProClip A **NEW**



AS 420 E-ProClip **NEW**



Lightweight and manoeuvrable in narrow surroundings

TECHNICAL SPECIFICATIONS

Accessories overview see page 68

| Model | Cutting width | Engine | Rated Voltage | Max. Voltage | Wheel drive, speed | Cutting height adjustment | Weight, dimensions | Item number |
|-------------------------|---------------|---|---------------|--------------|---------------------------|----------------------------|---|---------------------------------------|
| AS 420 E-ProClip | 42 cm | B&S 82Li Series 82V Lithium Ion Powerhead | 72 Volt | 82 Volt | — | central (30) 40–80 mm, 5 x | 25 kg (without battery) L 127 cm, B 46 cm, H 100 cm | G47000205 without battery and charger |
| AS 470 E-ProClip A | 47 cm | B&S 82Li Series 82V Lithium Ion Powerhead | 72 Volt | 82 Volt | 2,5 km/h Rear wheel drive | central (30) 40–80 mm, 5 x | 30 kg (without battery) L 131 cm, B 51 cm, H 100 cm | G47000104 without battery and charger |
| B&S lithium-ion-battery | | 5,0 Ah | 72 Volt | 82 Volt | | | 2,5 kg | G07300106 |
| B&S charger | | 4A | 82 Volt | | | | 1,5 kg | G07300107 |

AS PROFESSIONAL LAWN MOWERS



Similar to illustration, from season 2021 with Kawasaki engine.

WORKHORSES IN ACTION

Special demands are made of professionals. You must have a good amount of experience, special skills, and also a particular competence for problem-solving.

AS-Motor offers professionals the best solution: AS Professional Lawn Mowers, which can be described as real workhorses and rightly so.

Sturdy steel construction, large ball-bearing supported wheels, powerful engines, and ease of use are the main components of AS Professional Lawn Mowers. Taken together, this is the basis for professional handling with excellent performance. During long hours of use a large area can be cut without fatigue.

AS-Motor mowers are famous for their suitability on slopes – steep slopes with almost any incline can be climbed with the support of the two-stroke engine. For maximum comfort, there are models with four-wheel drive. The result: less effort, more fun at work, greater pride with the result.

IN FOCUS: AS PROFESSIONAL LAWN MOWER AS 531 2T ES MK B

The AS 531 offers agility in combination with outstanding stability and robustness. For one, the AS 531 has enormously reduced its weight, 20 % compared to the previous model, and the remaining weight has been optimally distributed between the axles.

For long continuous operation, the AS 531 is supported by elastomeric engine mounts for vibration reduction in addition to a particularly clever idea: the newly developed VibrationProtect damping system with its rubber-mounted V-link handle bar that makes the familiar tingling in the hands disappear.

In its top-version (AS 531 2T ES MK B or 4T MK B) this mower offers a special feature: It is the first hand-guided professional lawn mower with a factory standard safety brake and limited-slip differential. It combines ease of use with the utmost security. Releasing the blade clutch lever automatically stops the mower, which also acts as a parking brake that holds the mower in any position on the slope.

Now with easy-to-mount mulching kit as standard equipment. **3in1**

General product features :

| Model | Safety brake | Differential lock | Blade clutch | Variomatic speed | Third crankshaft bearing | Mulching kit included |
|-------------------|--------------|-------------------|--------------|------------------|--------------------------|-----------------------|
| AS 531 2T ES MK B | ● | ● | ● | ● | ● | ● |
| AS 531 4T MK B | ● | ● | ● | ● | ● | ● |
| AS 531 4T MK | — | — | ● | ● | ● | ● |

AS 531 with 3in1-function

The Professional profile: stable and weight-optimised steel structure, reduced hand-arm vibration by the VibrationProtect damping system, high-performance engines – either as AS 2-stroke engine or Honda four-stroke engine. The blade clutch stops the blade and the engine keeps on running. You can cross paths without affecting your environment by dangerous stone impact or raising unpleasant dust.

When emptying the grass collecting bag, just disengage the blade and empty the bag without cutting the engine. This provides maximum safety and, in addition, no need to restart the engine after blade stop. A unique operating concept: one hand controls the drive and blade clutch, whilst the other controls the speed which is continuous variable via Variomatic.

Technical highlight: the MK B models are equipped with differential-lock and drive down slopes with constant speed!

AS 531 2T ES MK B

AS 2-stroke engine with EasyStart reduces forces on the starter rope by 60% at half the pull distance



Stable frame construction protects the engine

Single-wheel height adjustment

Double ball bearing supported slim wheels

Shock absorbing and unbending feather-steel front axle



Function lever for the blade clutch

Variomatic-speed adjuster

Laterall adjustable handlebar

Mono bar: easy access to the bag

Collecting bag 75 l with fill level indicator

5 litre fuel tank

Ball-bearing supported wheels

Steel housing with side protection



Watch our videos on YouTube



3IN1-FUNCTION

Easy-to-mount mulching kit as standard equipment. Mow with collecting bag, rear discharge or mulching kit without collecting. (AS 531).



VIBRATION PROTECT

Through VibrationProtect system on the handlebar hand-arm vibrations are reduced to a minimum (AS 531).



VARIOMATIC

Infinitely variable speed adjustment in between minimum and maximum speed. This allows comfortable and steady propulsion (all devices).



SAFETY BRAKE

By releasing the blade clutch lever, the automatic parking brake is engaged. The mower is stopped safely for emptying the bag even on slopes (only on MK B models).



3rd CRANKSHAFT BEARING

Crankshaft with additional 3rd ball-bearing and friction clutch on blade for maximum engine protection against blade impacts. Galvanised steel mowing deck (all models).



WEIGHT DISTRIBUTION

Sophisticated stability and weight distribution for ergonomic handling and fatigue-reduced working.

AS 531 4T MK B

Powered by Kawasaki

Equipped with 4-Stroke Engine, blade clutch, brake, differential lock and variomatic



AS 53 2T ES 4WD RB



Equipped with four-wheel drive, reverse gear, brake, EasyStart and side discharge



TECHNICAL SPECIFICATIONS

Accessories overview see page 68

| Model | Cutting width | Engine | Rated power | Maximum engine power | Wheel drive, speed | Cutting height adjustment | Weight, dimensions | Item number |
|-------------------|---------------|--------------------------------------|--|--|--|---------------------------|----------------------------------|-------------|
| AS 531 2T ES MK B | 53 cm | AS 2-stroke ES, 165 ccm | 2,8 kW (3,8 hp) at 2.800 min ⁻¹ | 4,4 kW (6,0 hp) at 4.500 min ⁻¹ | Variomatic 3,0–4,5 km/h Rear wheel drive | By wheel 30–80 mm, 6 x | 57 kg L 164 cm, W 59 cm, H 99 cm | G53100113 |
| AS 531 4T MK B | 53 cm | Kawasaki 4-stroke FJ180V KAI 180 ccm | 2,9 kW (4,0 hp) at 2.800 min ⁻¹ | 3,4 kW (4,6 hp) at 3.600 min ⁻¹ | Variomatic 3,0–4,5 km/h Rear wheel drive | By wheel 30–80 mm, 6 x | 61 kg L 164 cm, W 59 cm, H 99 cm | G53100115 |
| AS 531 4T MK | 53 cm | Kawasaki 4-stroke FJ180V KAI 180 ccm | 2,9 kW (4,0 hp) at 2.800 min ⁻¹ | 3,4 kW (4,6 hp) at 3.600 min ⁻¹ | Variomatic 3,0–4,5 km/h Rear wheel drive | By wheel 30–80 mm, 6 x | 60 kg L 164 cm, W 59 cm, H 99 cm | G53100114 |

TECHNICAL SPECIFICATIONS

Accessories overview see page 68

| Model | Cutting width | Engine | Rated power | Maximum engine power | Wheel drive, speed | Cutting height adjustment | Weight, dimensions | Item number |
|--|---------------|-------------------------|--|--|--|---------------------------|----------------------------------|-------------|
| AS 53 2T ES 4WD RB with reverse gear and brake | 53 cm | AS 2-stroke ES, 165 ccm | 2,8 kW (3,8 hp) at 2.800 min ⁻¹ | 4,4 kW (6,0 hp) at 4.500 min ⁻¹ | Variomatic, 3,1–4,8 km/h All-wheel drive | By axle 30–100 mm, 6 x | 68 kg L 178 cm, W 82 cm, H 99 cm | G04400101 |
| AS 53 2T ES 4WD without reverse gear and brake | 53 cm | AS 2-stroke ES, 165 ccm | 2,8 kW (3,8 hp) at 2.800 min ⁻¹ | 4,4 kW (6,0 hp) at 4.500 min ⁻¹ | Variomatic, 3,1–4,8 km/h All-wheel drive | By axle 30–100 mm, 6 x | 67 kg L 178 cm, W 82 cm, H 99 cm | G04300102 |



OUR BRUSH CUTTERS ARE CALLED ALLMÄHER®

The AS Allmäher® principle has been alive since 60 years.

In 1959 our founder, Alfred Schefenacker, invented a brush mower with a sickle mowing system and mulching capability, which today is known all over the world. He named this mower according to its purpose – Allmäher® or Allmower translated into English.

The initial goal was to find an easier way to mow the steep slopes of the local vineyards around Stuttgart – thus making life easier for the winegrowers. Robustness and sturdiness was of great importance so that the mower could face these challenging requirements. Yet at the same time, the mower needed to be agile and compact to get through the steep and narrow terrain. So AS-Motor set out to develop a completely unprecedented mower at that time – one that could cut tall grass and crush woody grapevine prunings easily. This revolutionized the brush cutter market: the Allmäher® era began.

The Allmäher® also became the classic among extensive mulching mowers, a technique that AS-Motor has perfected in its present Allmäher® models. Via extensive mulching, tall grass is mowed down, and then chopped up and crushed. This process is required only a few times per year. The cut grass is so finely shredded that it disappears between the stalks left standing and quickly rots and disappears.

Born on the steep slopes of the South German vineyards, the Allmäher® has grown up around the world on large and densely vegetated areas, in embankments and on roadsides, in orchards and anywhere else where grass only gets cut a few times per year – by both private and professional users. The Allmäher®'s applications have now multiplied – since the Allmäher® is constantly being improved by the developers and engineers of AS-Motor.

The name says it all – there is hardly any job the Allmäher® cannot handle.



Lovingly restored by an enthusiastic customer:
AS motor Allmäher® AS 26 AH 4.
Year of construction 1976, with front wheel drive
by flexible drive shaft, 92 cm³ AS 2-stroke engine,
4,7 hp at 5.200 rpm.

AS 28 2T ES

The technology of our most popular classic has been perfected by the 3-wheel concept – it is ideal for mowing around bends and in corners. At the same time getting through even the most difficult terrain is no problem for the Allmäher® with its inflatable agricultural tread tyres and robust mowing/mulching unit.

This Allmäher® is easy to manoeuvre, thanks to vibration dampers and 2-speed drive. The rear wheel brake serves as both a parking brake and a safety brake.



TECHNICAL SPECIFICATIONS

| Model | Cutting width | Engine | Rated power | Maximum engine power | Wheel drive, speed | Cutting height adjustment | Weight, dimensions | Item number |
|-------------|---------------|-------------------------|--|--|-----------------------------------|---------------------------|-------------------------------------|-------------|
| AS 28 2T ES | 63 cm | AS 2-stroke ES, 165 ccm | 4,0 kW (5,4 hp) at 3.800 min ⁻¹ | 4,4 kW (6,0 hp) at 4.500 min ⁻¹ | Rear wheel drive 1,9 and 3,4 km/h | By axle 55–130 mm, 4-fach | 77 kg L 195 cm, W 92 cm, H 99 cm | G06300103 |

Accessories overview see page 69



VARIABLE FRONT WHEEL

Better manoeuvring: the large front wheel is height adjustable, it pivots and can be locked in place for easy traversing on slopes.



SNORKEL FILTER

High-positioned snorkel filter ensures that clean air is suctioned in when working in dusty conditions (2-stroke engines).



DRIVE WHEELS

Agricultural tread tyres combined with a two speed rear wheel drive propulsion system (AS 28).



REAR BRAKE

Lockable rear brakes for better handling when moving downhill (accessory for AS 26 and AS 21, standard in AS 28).



TECHNICAL SPECIFICATIONS

Accessories overview see page 69

| Model | Cutting width | Engine | Rated power | Maximum engine power | Wheel drive, speed | Cutting height adjustment | Weight, dimensions | Item number |
|------------------|---------------|--|--|--|---------------------------|------------------------------|-------------------------------------|-------------|
| AS 26 2T ES | 63 cm | AS 2-stroke ES, 165 ccm | 4,0 kW (5,4 hp) at 3.800 min ⁻¹ | 4,4 kW (6,0 hp) at 4.500 min ⁻¹ | Rear wheel drive 2,4 km/h | By wheel 55–80 mm, 2 and 4 x | 58 kg L 195 cm, W 89 cm, H 99 cm | G06300102 |
| AS 21 2T ES | 51 cm | AS 2-stroke ES, 165 ccm | 4,0 kW (5,4 hp) at 3.800 min ⁻¹ | 4,4 kW (6,0 hp) at 4.500 min ⁻¹ | Rear wheel drive 2,4 km/h | By wheel 55–80 mm, 2 and 4 x | 54 kg L 195 cm, W 74 cm, H 99 cm | G06100103 |
| AS 21 4T Comfort | 51 cm | B&S 4-stroke, 850E-Series I/C, 190 ccm | 3,6 kW (4,9 hp) at 3.300 min ⁻¹ | 4,1 kW (5,5 hp) at 3.600 min ⁻¹ | Rear wheel drive 3,0 km/h | By wheel 55–80 mm, 2 and 4 x | 50 kg L 200 cm, W 74 cm, H 99 cm | G06100102 |
| AS 21 4T B&S | 51 cm | B&S 4-stroke, 850E-Series I/C, 190 ccm | 3,6 kW (4,9 hp) at 3.300 min ⁻¹ | 4,1 kW (5,5 hp) at 3.600 min ⁻¹ | Rear wheel drive 3,0 km/h | By wheel 55–80 mm, 2 x | 41 kg L 165 cm, W 71 cm, H 99 cm | G06100101 |



AS 2-stroke engine with EasyStart



Drive lever
Handlebar side adjustment
Parking brake
Blade clutch
Vibration and impact damping
Variomatic speed regulation
Handlebar height adjustment
New tank shape 3-litre with reserve function
Mow to the last drop
Stable, 4-edge beam construction protects the engine
Rear height adjustment
Variable cutting height adjustment
Stable forks made of Hardox®
Pivoting and lockable front wheels
Stone impact protective cloth
Inflatable profile wheels
Twin tyres available, see accessories
Snorkel filter (optional on AS 63 2T)
Engine crankshaft and bladeshaft are separated: Engine protection on impacts

AS 63 2T ES

Mulch and mow in one step
The cross-blade system of the AS 63 Allmäher® easily cuts and chops even high growth and impresses with its outstanding cutting performance and excellent mulching result.

Permanent traction, manoeuvrability and safety
The robust transmission with limited-slip differential ensures reliable propulsion and enables safe working even on difficult, steep terrain and on wet soil.

Conical mower hood – perfect cut
The conical, rear-taper mower deck, as well as the pivot wheels attached outside of the cutting pattern, ensure an optimal inflow of the material that will be cut by the cross-blade. Through this design the grass is cut in a relatively upright, ideal position, with excellent cutting and mulching results.

Steep slope power, high performance, safety and easy handling
The low weight (approx. 78 kg), good ergonomics with anti-vibration system and powerful, robust motorisation make the AS 63 the ideal mower on slopes. In this regard, the 2-stroke engine variant is extremely powerful and offers extreme climbing ability. For the first time, the redesigned 2-stroke engine is equipped with a convenient EasyStart function, and has an electronic ignition.

Your safety is important to us!
The AS 63 has an automatic speed limiter for driving downhill, an automatic limited-slip differential and an automatic parking brake that engages when releasing the traction drive.





MULCHING KIT
Optional accessory for an even finer mulching result and a more uniform cutting pattern on lawn-like areas with grass up to 40 cm high.



BLADE SYSTEM
Double-blade system for an outstanding cutting pattern and good mulching effect. Heavy duty blade support with triple ball-bearing.



TWIN TYRES, OPTIONAL
Twin tyres with quick-release fasteners are optionally available for steep slopes (not for AS 63 4T Honda).



VIBRATION DAMPING
Through vibration and impact damping, hand-arm vibration is reduced to a minimum.



VARIOMATIC
The speed regulator enables variable adjustment of the drive speed.



EASY TRANSPORT
Compact: the AS 62 and 63 are foldable for transport. Min. height: 70 cm.

AS 63 4T B&S



Vertical service position
Easy access for cleaning and servicing.

Accessories overview see page 70

| Model | Cutting width | Engine | Rated power | Maximum engine power | Wheel drive, speed | Cutting height adjustment | Weight, dimensions | Item number |
|----------------|---------------|--|--|--|---|--|-------------------------------------|-------------|
| AS 63 2T ES | 61 cm | AS 2-stroke ES, 165 ccm | 4,0 kW (5,4 hp) at 3.800 min ⁻¹ | 4,4 kW (6,0 hp) at 4.500 min ⁻¹ | Variomatic 2,0–4,0 km/h Rear wheel drive | Front variable, rear 4-position, 50–100 mm | 78 kg L 191 cm, W 70 cm, H 99 cm | G60000105 |
| AS 63 4T B&S | 61 cm | B&S 4-stroke, 850E-Series I/C, 190 ccm | 3,7 kW (5,1 hp) at 3.600 min ⁻¹ | 4,1 kW (5,5 hp) at 3.600 min ⁻¹ | Variomatic 1,8–3,8 km/h Rear wheel drive | Front variable, rear 4-position, 50–100 mm | 74 kg L 191 cm, W 70 cm, H 99 cm | G60000104 |
| AS 63 4T Honda | 61 cm | Honda 4-stroke GXV-160, 163 ccm | 3,2 kW (4,3 hp) at 3.600 min ⁻¹ | 3,2 kW (4,3 hp) at 3.600 min ⁻¹ | Variomatic 1,8–3,8 km/h Rear wheel drive | Front variable, rear 4-position, 50–100 mm | 82 kg L 191 cm, W 70 cm, H 99 cm | G60000103 |



EXCELLENT MOWING POWER, PERFECT MANOEUVRABILITY

The AS 62 4T B & S does not make any compromise in mowing performance and cutting finish. Compared to his bigger brother the AS 63 4T B&S the advantages of the AS 62 4T are its easy steering and its high agility around obstacles in flat and slightly uneven terrain. Slope or no slope – that's the question now for choosing the right model for you.

AS 62 4T B&S Allmäher®

In its class the AS 62 4T B&S offers an outstanding cutting-power to ambitious private users. The freewheel drive and the movable front wheels allow comfortable steering and turning while driving.

Ideal when mowing around obstacles, in orchards, gardens, on flat ground and on gentle slopes.



Watch our videos on
YouTube



BLADE SYSTEM

Double-blade system for an outstanding cutting pattern and good mulching effect. Heavy duty blade support with triple ball-bearing.



ENGINE PROTECTION

Engine crankshaft and blade-shaft are separated by a blade clutch: thus the engine is protected from impacts when the blades are hitting foreign objects.



BIG DRIVE WHEELS

The extra large strong drive wheels with 30 cm diameter provide good traction.



MULCHING KIT

Optional accessory for an even finer mulching result and a more uniform cutting pattern with grass up to 40 cm high.

TECHNICAL SPECIFICATIONS

| Model | Cutting width | Engine | Rated power | Maximum engine power | Wheel drive, speed | Cutting height adjustment | Weight, dimensions | Item number |
|--------------|---------------|--|--|--|---|--|-------------------------------------|-------------|
| AS 62 4T B&S | 61 cm | B&S 4-stroke, 850E-Series I/C, 190 ccm | 3,7 kW (5,1 hp) at 3.600 min ⁻¹ | 4,1 kW (5,5 hp) at 3.600 min ⁻¹ | Variomatic 1,8–3,8 km/h Rear wheel drive | Front variable, rear 4-position, 50–100 mm | 66 kg L 191 cm, W 70 cm, H 99 cm | G60000202 |

Accessories overview see page 70



AS ALLMÄHERS® FOR PROFESSIONAL USE IN HARSH CONDITIONS

When the task at hand is professional care of green areas with high growth or on steep slopes Allmäher® models AS 65, and AS 73 are used. The AS 65 is available with two different engines: with an AS 2-stroke engine (6 hp) for extreme slopes or with a powerfull, slope capable B&S 4-stroke engine (13 hp) for maximum area performance.

AS 65 Allmäher®

The AS 65 guarantees permanent traction, manoeuvrability and safety via a differential lock in conjunction with a 5-speed manual transmission.

The AS-cross-blade system chops the grass reliably and produces an impressive mowing power, wherein the cutting force is maximised by an engine / blade coupling of 2:1.

Engine protection through separation of engine and blade shaft by blade clutch.



AS 65 4T B&S



Watch our videos on
YouTube



BLADE SYSTEM

The AS-cross-blade system cuts and chops at the same time, even high grass and undergrowth.



HEIGHT ADJUSTMENT

Easy, central cutting height adjustment, variable 50 – 100 mm.



MANUAL TRANSMISSION

The 5-gear manual transmission with reverse-gear and differential lock ensures optimal drive even in difficult terrain.



AUTOMATIC BRAKE

When releasing the drive lever the machine will immediately stop even on steep slopes.

TECHNICAL SPECIFICATIONS

Accessories overview see page 70

| Model | Cutting width | Engine | Rated power | Maximum engine power | Wheel drive, speed | Cutting height adjustment | Weight, dimensions | Item number |
|--------------------------------------|---------------|--------------------------------------|---|---|---|-----------------------------|--------------------------------------|-------------|
| AS 65 2T ES | 65 cm | AS 2-stroke ES, 165 ccm | 4,0 kW (5,4 hp) at 3.800 min ⁻¹ | 4,4 kW (6,0 hp) at 4.500 min ⁻¹ | Rear-Wheel drive 1,4–4,1 km/h, reverse 1,9 km/h | central, 50–100 mm variable | 114 kg L 220 cm, W 71 cm, H 99 cm | G06700102 |
| AS 65 4T B&S with oil- and fuel pump | 65 cm | B&S 4-stroke Series 3 INTEK, 344 ccm | 7,6 kW (10,3 hp) at 3.300 min ⁻¹ | 9,7 kW (13,0 hp) at 3.600 min ⁻¹ | Rear-Wheel drive 1,6–5,1 km/h, reverse 2,4 km/h | central, 50–100 mm variable | 125 kg L 220 cm, W 71 cm, H 99 cm | G06700008 |



THE ALLROUNDER AMONG THE PROFESSIONAL ALLMÄHERS

Due to its two selectable blade speeds, the AS 73 Allmäher® is particularly versatile. Use it as a powerful scrub and high grass mower with high blade torque or create a visually appealing cutting finish with high blade speed in medium to low grass. Park or Prairie – just flip the switch.

AS 73 Allmäher®

With this Allmäher®, you have a choice via Vario Speed: a faster blade speed to achieve a finer mulching result or a slower blade speed for higher torque in a tougher environment – an essential advantage when mowing less frequently cut, thick and tall grass.

Strong mowing performance with a high-torque B&S OHV engine, 5-speed rear-wheel drive and differential lock.



Watch our videos on
YouTube



BLADE SYSTEM

The AS-cross-blade system cuts and chops at the same time, even high grass and undergrowth.



REAR WHEELS

Low pressure tyres for strong traction on loose ground and slopes.



TWO BLADE SPEEDS

Switchable blade speed (Vario-speed). Highspeed for lower grass and top mulching. Low speed for high cutting power in dense grass and scrub.



CUTTING HEIGHT ADJUSTMENT

The cutting height adjustment is simple, central and infinitely variable.



TECHNICAL SPECIFICATIONS

| Model | Cutting width | Engine | Rated power | Maximum engine power | Wheel drive, speed | Cutting height adjustment | Weight, dimensions | Item number |
|-----------------|---------------|---|--|--|---|-------------------------------------|---|-------------|
| AS 73 4T B&S | 73 cm | B&S 4-stroke, Series 3 INTEK, 344 ccm | 7,6 kW (10,3 hp) at 3.300 min ⁻¹ | 9,7 kW (13,0 hp) at 3.600 min ⁻¹ | Rear-Wheel drive 1,6 – 5,1 km/h, reverse 2,4 km/h | central, 50 – 100 mm variable | 135 kg L 224 cm, W 79 cm, H 99 cm | G06700001 |

Accessories overview see page 70

AS FLAIL MOWERS



THE CLEVERER GIVE IN

Ditches, highway embankments and steep meadows, shrubbery and undergrowth – difficult tasks require special solutions when it comes to mowing and mulching. Someone that mows grass and undergrowth with a height of up to 1 meter only 2-3 times per year, frequently faces a tough challenge because often it is impossible to see obstacles and hidden foreign objects that can easily damage the machine.

Flail mowers mow with a horizontal axis of rotation. The flexibly mounted Y-blades, called flails, are mounted on an axle and can dodge hidden objects. Through the engine drive, the axis is rotated, and the variable-length flails, chop up thick undergrowth, branches, bushes and high grass into small pieces.

The remaining cuttings don't need to be laboriously raked together and removed, because they remain as mulch on the lawns, very quickly disappearing and fertilising the soil. Therefore this mowing method is perfectly suited for extensively used meadows, orchards, in parks or on roadsides.

IN FOCUS: AS FLAIL MOWER 901 SM

A 90 cm cutting width produces a strong area output performance. Comfortable manoeuvring is made possible through the single-wheel steering and braking clutch system in combination with a finely staged 5-speed manual transmission with differential lock. Patented dual tyres provide a masterful traction and braking effect.

Large diameter, profiled tyres as well as a strong wheel drive make work easier. Excellent manoeuvrability is achieved by two 360 degree swivel front wheels. Thus, this model is also suitable for steep slopes.

The protection of man and machine is very important. The stone guard made of a sturdy perforated metal shield protects you from swirled debris without obstructing the view.

Concerning cost/performance ratio the AS 901 SM is a class of it's own. Please compare yourself.

AS 901 SM

Robust flail mowing deck with twenty-six 3mm thick Y-flails. Precise, safe and convenient working guaranteed by the unique mechanic single wheel steering system which combines brake and clutch at the same time, finely with a staged 5-speed manual transmission with differential lock and reverse gear and large agricultural dual tyres.

The low weight, the low centre of gravity, the perfect balance and the steering brake make the AS 901 SM the perfect slope mowing machine for professionals.



Certified stone-throw protection

Vanguard 2-cylinder engine with oil and gas pump, suitable for working on slopes

Side and height adjustable, foldable handle

Teflon-coated stainless steel Bowden cables significantly reduce the operating forces

Mechanical steering brake with diff-lock

Agricultural tread twin tyres for optimal lateral guidance when mowing transverse to the slope

New reinforced axle and drive system for the use of steel wheels

Integrated lashing points

Impact guard

Swivel, heavy-duty front wheels

Stone guard flaps



Watch our videos on YouTube

TECHNICAL SPECIFICATIONS

Accessories overview see page 71

| Model | Cutting width | Engine | Rated power | Maximum engine power | Wheel drive, speed | Cutting height adjustment | Weight, dimensions | Item number |
|-----------|---------------|---|--|--|---|---------------------------|-------------------------------------|-------------|
| AS 901 SM | 90 cm | B&S 4-stroke, 2-cylinder Vanguard, V-Twin 480 ccm | 10,7 kW (14,5 hp) at 3.500 min ⁻¹ | 11,9 kW (16,0 hp) at 3.600 min ⁻¹ | Rear-Wheel drive 1,2 – 4,0 km/h, reverse 1,8 km/h | central 10 – 100 mm, 6 x | 215 kg L 220 cm, W 104 cm, H 105 cm | G90100001 |



BLADE SYSTEM

Steel housing with horizontal flail mowing deck, 20 respectively 26 pairs of Y-flails cut and mulch up grass and scrub. Double-safety stone guard to the back.



MACHINE CONTROL

Turn on a sixpence, the steering clutch makes it possible.



HEIGHT ADJUSTMENT

Easy height adjustment of the mower deck via lever.



MANUAL TRANSMISSION

The 5-gear manual transmission with differential lock, ensures optimal drive even on a wet surface.

AS 701 SM



Certified stone-throw protection

Teflon-coated stainless steel Bowden cables significantly reduce the operating forces

Side and height adjustable, foldable handle

B+S engine with oil and fuel pump, suitable for working on slopes

Mechanical steering brake with diff-lock

Agricultural tread tyres

Integrated lashing points

Impact safety guard

Flail mower deck oscillatingly suspended

Stone guard flaps

Swivel, heavy-duty front wheels



TECHNICAL SPECIFICATIONS

Accessories overview see page 71

| Model | Cutting width | Engine | Rated power | Maximum engine power | Wheel drive, speed | Cutting height adjustment | Weight, dimensions | Item number |
|-----------|---------------|--|---|---|---|---------------------------|------------------------------------|-------------|
| AS 701 SM | 70 cm | B&S 4-stroke, 1-cylinder Series 3 Intek, 344 ccm | 7,6 kW (10,3 hp) at 3.300 min ⁻¹ | 9,7 kW (13,0 hp) at 3.600 min ⁻¹ | Rear-Wheel drive 1,1 – 3,6 km/h, reverse 1,7 km/h | central 10 – 100 mm, 6 x | 196 kg L 220 cm, W 84 cm, H 105 cm | G90100701 |

AS ROTARY MOWERS



ANIMAL FEED PRODUCTION MADE EASY

AS Rotary Mowers cut the grass at full length very close to the soil surface and place it in neat rows, as swaths. Collecting the cut grass is then very simple and the hassle of raking the grass is completely eliminated. In terms of work pace and comfort our Rotary Mowers make outdated cutter bars obsolete.

AS 585 KM



Adjustable handlebar to individual working height

Blade clutch

AS 625 KM



Watch our videos on
 YouTube



Adjustable boom for depositing the cut grass

Stone guard cloth

Steel cover with handle for transport

Two driving speeds by turning over the belt

Rear wheels with manual lockable differential

Safety guard



BLADE SYSTEM

Rotary mower disc with double-edge sharpened and hardened blades. Usable on both sides.



UNIFORM SWATHS

AS rotary mowers leave grass unchopped, thereby creating an inexpensive source of healthy pet and animal feed.

TECHNICAL SPECIFICATIONS

Accessories overview see page 71

| Model | Cutting width | Engine | Rated power | Maximum engine power | Wheel drive, speed | Weight, dimensions | Item number |
|-----------|---------------|---------------------------------------|--|---|---|--------------------------------------|-------------|
| AS 585 KM | 62 cm | 4-stroke OHV, XP 200, 196 ccm | 3,0 kW (4,4 hp) at 3.200 min ⁻¹ | 3,6 kW (4,8 hp) at 3.800 min ⁻¹ | Wheel drive 2,4 km/h | 66 kg L 173 cm, W 82 cm, H 119 cm | G05900105 |
| AS 625 KM | 62 cm | B&S 4-stroke, 875 EXi Series, 190 ccm | 3,5 kW (4,8 hp) at 3.200 min ⁻¹ | 4,1 kW (5,5 hp) bat 3.600 min ⁻¹ | Wheel drive 2,0 km/h (2,7 km/h, by turning over the V-belt) | 67 kg L 173 cm, W 82 cm, H 119 cm | G05900104 |

AS IMPLEMENT CARRIER AND ATTACHMENTS



"MAKE HAY WHILE THE SUN SHINES!" PROVERBIAL WISDOM.

"Let it bloom longer and mow later"—are currently full in trend. Today, in particular, infrequently (extensively) maintained marginal areas are valuable habitats for a variety of plant and animal species. To preserve these areas and develop them ecologically in the interest of biodiversity, requires an individual care concept that is appropriate for the respective location.

In this regard the principle behind all measures is: As much care as necessary, as little intervention as possible. Minimizing the number of yearly mowings (max. 1-2 mowings per year) combined with selectively collecting of the hay or targeted emaciation of soil, favours the biodiversity of flora. At the same time it is also important to protect insects, small creatures and other animals and not abruptly and permanently damage their habitat.

However, increasing scrub encroachment must be prevented in every case, otherwise biodiversity of flora and fauna will be reduced. Not mowing and not maintaining are not alternatives.

IN FOCUS: THE AS 600 MULTIPRO IMPLEMENT CARRIER WITH DOUBLE-BLADE CUTTER BAR

Oscillating grass cutting technologies, better known as cutter bar mowers, are particularly gentle on insects and small creatures when mowing. The triangular blades that run counter to each other cleanly cut off the grass, like a pair of scissors. Grasses and plants remain unchopped, full-length on the surface and start drying. In good weather conditions the grass can quickly dry and then through windrowing and collecting it can be used as hay.

Cuttings can be removed manually with a loading vehicle or bale press. For the new AS 600 MultiPro there are two double-blade cutter bars to choose from. For this type of cutter bar the upper and lower cutting blades move counter to each other. The advantages in this regard are vibration-free mode of operation, no clogging and high mowing speed.

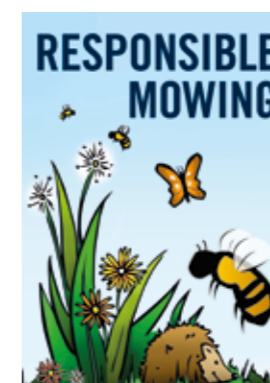

For detailed information
about **ecologically oriented**
green space maintenance:



AS 600 MultiPro – the versatile, special implement **NEW**

Eco-friendly, extensive grassland care saves time and money. Particularly when you can also use the machine that is required in this regard for other applications. For the AS 600 MultiPro there is also a flail mower for matted grass and undergrowth, as well as a sweeping brush for cleaning paths and public places, for example after using mechanical weed brushes.



Illustration with ESM cutter bar



Watch our videos on YouTube

Accessories overview see page 72

TECHNICAL SPECIFICATIONS

| Model | Engine | Rated power | Maximum engine power | Wheel drive, speed | Weight, dimensions | Item number |
|--------------------------------------|---------------------------------|---|---|---|--|-------------|
| AS 600 MultiPro Implement carrier | Honda GX 270 OHV, 270 ccm | 5,6 kW (7,6 hp) at 2.900 min ⁻¹ | 6,3 kW (8,6 hp) at 3.600 min ⁻¹ | Hydrostat, foreward: 0 – 5,3 km/h reverse: 0 – 2,4 km/h | 90 kg L 200 cm, W 80 cm, H 97 cm | G90900101 |



ESM CUTTER BAR

- Professional double blade cutter bar 126 cm
- 2-fold oscillating guide-levers BIDUX-system
- High-quality center drive in oil bath
- Blade stroke relative 84 mm
- Tooth pitch 70/84 mm, smooth
- Particularly low-vibration and quiet
- No clogging
- Suitable for all types of grasses
- High mowing speed up to 5 km/h
- Easy maintenance



LOSI CUTTER BAR

- Robust double blade cutter bar 117 cm
- Suitable for professional use
- Simple swing arm guide levers, Busatis system
- Robust center drive in oil bath
- Blade stroke relative 85 mm
- Tooth pitch 85/42,5 mm, toothed
- Low-vibration, gentle on machines
- No clogging
- Especially suitable for medium and coarse (rough) grass
- High mowing speed



FLAIL MOWER DECK

- Y-flails for high grass and scrub up to 80 cm
- Continuous cutting height adjustment



SWEEPING BRUSH

- Sweeping width 100 cm
- Brush diameter 400 mm
- Pivotable left/right
- Height-adjustable wheels
- Ideal for sweeping and cleaning after mechanical weed removal and winter service

TECHNICAL SPECIFICATIONS

Accessories overview see page 72

| Modell | Cutting width | Cutting height | Cutting height adjustment | Cutting system | Weight | Item number |
|------------------|---------------|----------------|---------------------------|---------------------------------|--------|-------------|
| ESM cutter bar | 126 cm | 4 – 12 cm | stepless via skids | Double blade 70/84, smooth | 64 kg | G90900102 |
| LOSI cutter bar | 117 cm | 4 – 12 cm | stepless via skids | Double blade 85/42,5, toothed | 49 kg | G90900103 |
| Flail mower deck | 68 cm | 3 – 11 cm | stepless via crank | Rotor with 16 pairs of y-flails | 70 kg | G90900104 |
| Sweeping brush | 100 cm | – | – | – | 61 kg | G90900105 |

AS RIDE-ON ALLMÄHER



MAXIMUM COMFORT FOR EXTRAORDINARY TASKS

Lawn tractors are not designed to mow meadows, and certainly not dense growth. Clogged mower decks, smoking belts and bent blades are often the result.

Thus AS-Motor created the ride-on Allmäher which combines the comfort and the work rate of a lawn tractor with the cutting force and all-terrain mobility of AS-Motor's well-known Allmäher. Essential design features include a stable blade system, drive gear ratios, a low centre of gravity and drive and cooling systems which ensure endurance and performance.

AS-Motor offers eleven different models depending on the operator's needs. 2WD models are the right choice for agility and high work rates on level terrain, while the permanent all-wheel drive of the AS 940 Sherpa make it the preferred tool of landscape gardeners, municipalities and service providers on steep slopes and difficult terrain.

| Model | Cutting width | Max. under-growth height | Hydrostatic drive | Differential lock | Mowing deck | Blade system |
|----------------------|---------------|--------------------------|-------------------|-------------------|-------------------------------------|--|
| AS 799 Rider | 80 cm | 60 cm | 2WD | — | Rear discharge | Single-blade, fixed |
| AS 800 Freerider | 80 cm | 80 cm | 2WD | ● | Rear discharge | Cross-blade, fixed |
| AS 900 Enduro | 90 cm | 120 cm | 2WD | ● | Side discharge | Single-blade (exchangeable blade tips) |
| AS 915 Sherpa 2WD | 90 cm | 120 cm | 2WD | ● | Surfing, rear discharge | Cross-blade (pendulum-blades below) |
| AS 920 Sherpa 2WD | 90 cm | 150 cm | 2WD | ● | Surfing, reinforced, rear discharge | Cross-blade (pendulum-blades below) |
| AS 940 Sherpa 4WD | 90 cm | 150 cm | 4WD | ● | Surfing, reinforced, rear discharge | Cross-blade (pendulum-blades below) |
| AS 940 Sherpa 4WD XL | 90 cm | 150 cm | 4WD | ● | Surfing, reinforced, rear discharge | Cross-blade (pendulum-blades below) |
| AS 940 Sherpa 4WD RC | 90 cm | 150 cm | 4WD | ● | Surfing, reinforced, rear discharge | Cross-blade (pendulum-blades below) |
| AS 1020 YAK 2WD | 100 cm | 150 cm | 2WD | ● | Surfing, rear discharge | 28 pairs of Y-Flails |
| AS 1040 YAK 4WD | 100 cm | 150 cm | 4WD | ● | Surfing, rear discharge | 28 pairs of Y-Flails |
| AS 1040 YAK 4WD XL | 100 cm | 150 cm | 4WD | ● | Surfing, rear discharge | 28 pairs of Y-Flails |



CUTTING HEIGHT ADJUSTMENT
Four step adjustment with transport-position and safety blade stop.



SEATING COMFORT
For the models AS 799 and AS 800 an optional seat suspension system is available. Adjustable, with gas-pressure damper.
(AS 799 from serial no. 0301 17 10 0001, (AS 800 from serial no. 0300 17 10 0001)



TRANSMISSION
Variable hydrostatic transmission — forward/reverse with differential lock and rear wheel brake (Differential lock only with AS 800).



BLADE SYSTEM
Cross-blade mulching system. One cutting blade with upper mulching blade and triple ball bearing blade support (AS 800).



BLADE SYSTEM
Closed mower deck with single-blade system with triple ball bearing blade support (AS 799).

AS 799 RIDER



AS 800 FREERIDER



AS 799 RIDER / AS 800 FREERIDER

Take a seat and get started. Our AS 799 and AS 800 provide an easy entry into our family of AS ride-on mowers. Ambitious private users that need to mow large areas, slightly rolling terrain and around obstacles will love these machines. Grass and weeds up to 80 cm (AS 800) are no problem at all. A low centre of gravity and an spacious seating position provide safety and comfort – even for tall people.



TECHNICAL SPECIFICATIONS

Accessories overview see page 72

| Model | Cutting width | Engine | Rated power | Maximum engine power | Wheel drive, speed | Cutting height adjustment | Weight, dimensions | Item number |
|------------------|---------------|--|---|---|--|---------------------------|-----------------------------------|-------------|
| AS 799 Rider | 80 cm | B&S 4-stroke, Series 3 Powerbuilt, 344 ccm | 6,5 kW (8,8 hp) at 3.200 min ⁻¹ | 7,8 kW (10,6 hp) at 3.600 min ⁻¹ | Hydrostat variable forward: 0–8,0 km/h reverse: 0–6,0 km/h | central 35–85 mm, 4 x | 204 kg L 170 cm, W 87 cm, H 96 cm | G06800102 |
| AS 800 FreeRider | 80 cm | B&S 4-stroke, Series 3 INTEK, 344 ccm | 7,6 kW (10,3 hp) at 3.200 min ⁻¹ | 9,7 kW (13,0 hp) at 3.600 min ⁻¹ | Hydrostat variable forward: 0–8,0 km/h reverse: 0–6,0 km/h | central 35–85 mm, 4 x | 231 kg L 170 cm, W 87 cm, H 96 cm | G06800101 |



POWER IN THE FIELD

Tough mowing challenge? Grass heights up to 1.20m? Don't torment yourself, use our AS 900. The rear-wheel drive with differential lock and high-traction tyres will carry you along on uneven terrain. The side ejection cutting deck handles high grass and brush with ease.

AS 900 ENDURO

Optional seat suspension kit available

B&S 4-Stroke-Engine with oil and fuel pump

Sturdy all-round self-supporting tubular frame

Electro-magnetic blade clutch

Smooth running gear wheel steering

15 litre fuel tank for long range

Front guard

Cutting height adjustment, 4x

Mower deck with side discharge

Stepless 2 WD hydrostatic drive with additional cooling

Watch our videos on

YouTube

DIFFERENTIAL LOCK

Differential lock for rough terrain. Lockable parking brake on rear axle.

BLADE SYSTEM

Mono-blade system with exchangeable blade tips and side ejection.

COMFORT

Comfortable and ergonomically optimised sitting position with AS-Motor bucket seat. Optional seat suspension available.

BUMPER

Stable bumper protects axles, steering and wheels.

TECHNICAL SPECIFICATIONS

Accessories overview see page 72

| Model | Cutting width | Engine | Rated power | Maximum engine power | Wheel drive, speed | Cutting height adjustment | Weight, dimensions | Item number |
|---------------|---------------|---|--|--|--|---------------------------|-------------------------------------|-------------|
| AS 900 Enduro | 90 cm | B&S 4-stroke, 2-Zylinder, Series 7 INTEK, 656 ccm | 11,1 kW (15,1 hp) at 3.300 min ⁻¹ | 11,9 kW (16,2 hp) at 3.600 min ⁻¹ | Hydrostat Variable, forward: 0 – 10,0 km/h reverse: 0 – 9,5 km/h | central 50 – 90 mm, 4 x | 298 kg, L 183 cm, W 100 cm, H 95 cm | G06600102 |



AS 915 SHERPA 2WD: WELCOME TO THE SHERPA CLASS

Our well-known ride-on mower AS 915 Enduro became the new AS 915 Sherpa 2WD. All the main advantages of the Sherpa are on-board: surfing mowing deck, cross-blade system, comfortable seating position and the one-hand driving lever. Super agile driving behavior and the tight turning circle is typical for our 2WD machines. Reliable cutting power is delivered by the 18 hp 2-cylinder B&S engine with 656 ccm. Take a seat and mow along in a real Sherpa!

AS 915 SHERPA 2WD



Watch our videos on
YouTube



CROSS-BLADE SYSTEM

AS high grass mowing deck with interchangeable cutting-blades and fixed upper mulching blade.



NARROW TURNING CIRCLE

Pendulum front axle and smooth steering for agile driving behaviour. Inner turning radius of just 65 cm.



ROBUST ENGINE

Professional 18hp B&S 2-cylinder 4-stroke engine with fuel and oil pump. Easy access to oil dipstick and air filter.



SURFING MOWER DECK

The Sherpa mower deck is designed to follow uneven ground and edges with a surfing vertical movement providing additional ground clearance and avoiding ground contact with the blades.

TECHNICAL SPECIFICATIONS

Accessories overview see page 73

| Model | Cutting width | Engine | Rated power | Maximum engine power | Wheel drive, speed | Cutting height adjustment | Weight, dimensions | Item number |
|-------------------|---------------|---|--|--|---|-----------------------------|---------------------------------------|-------------|
| AS 915 Sherpa 2WD | 90 cm | B&S 4-stroke, 2-cylinder, Professional Series 7220, 656 ccm | 13,3 kW (18,0 hp) at 3.300 min ⁻¹ | 16,4 kW (22,0 hp) at 3.600 min ⁻¹ | 2-wheel drive Hydrostat variable, forward: 0 – 10,5 km/h reverse: 0 – 8,2 km/h | central 50 – 105 mm, 5 x | 270 kg L 191 cm, W 98 cm, H 100 cm | G06900601 |

AS 940 SHERPA 4WD XL / AS 940 SHERPA 4WD / AS 920 SHERPA 2WD

Terrain too rough for a normal ride-on mower? No problem. Grass and brush up to 1.5m high are no match for the AS 940 Sherpa's powerful engine, permanent all-wheel drive, differential lock and the AS cross-blade cutting system.

A robust yet agile design and low centre of gravity make the Sherpa rock-solid on slopes and rough terrain. Our engineers have packed the best of 60 years' experience into this machine, which is why the Sherpa is the preferred high-grass ride-on mower for professional use on slopes and rough-terrain.

For even more demanding terrain the Sherpa is now available in XL – large agricultural tyres provide even higher ground clearance and stability.



BLADE SYSTEM

Reinforced AS high grass mowing deck with interchangeable blades and upper cross-blade. Shown with optional mulching kit.



ALL-WHEEL DRIVE

Permanent all-wheel drive, better traction up- and downhill, more secure brake impact (does not apply for AS 915 and AS 920 Sherpa 2WD).



COMFORT AT IT'S BEST

Leg room for tall operators, unique AS one hand driving lever with integrated parkbrake, adjustable seat suspension, side guards and smooth steering.



SURFING MOWER DECK

The Sherpa mower deck is designed to follow uneven ground and edges with a surfing vertical movement providing additional ground clearance and avoiding ground contact with the blades.

AS 940 SHERPA 4WD

With ATV-tyre tread, wheel size standard
front: 15x5.00-6
rear: 18x9.50-8



AS 920 SHERPA 2WD

In response to many requests, now the Sherpa is also available with 2-wheel drive for terrain with moderate slopes. It offers agile driving behaviour thanks to a turning radius of just 65 cm and a top speed of 10,5 km/h.



TECHNICAL SPECIFICATIONS

Accessories overview see page 73

| Model | Cutting width | Engine | Rated power | Maximum engine power | Wheel drive, speed | Cutting height adjustment | Weight, dimensions | Item number |
|----------------------|---------------|--|--|--|---|---------------------------|-------------------------------------|-------------|
| AS 940 Sherpa 4WD XL | 90 cm | B&S 4-stroke 2-cylinder Professional Series 8, 724 ccm | 16,5 kW (22,4 hp) at 3.300 min ⁻¹ | 20,1 kW (27 hp) at 3.600 min ⁻¹ | Permanent all-wheel drive Hydrostat variable, forward: 0 – 6.7 km/h reverse: 0 – 6.5 km/h | central 80 – 135 mm, 5 x | 298 kg L 191 cm, W 106 cm, H 156 cm | G06900006 |
| AS 940 Sherpa 4WD | 90 cm | B&S 4-stroke 2-cylinder Professional Series 8, 724 ccm | 16,5 kW (22,4 hp) at 3.300 min ⁻¹ | 20,1 kW (27 hp) at 3.600 min ⁻¹ | Permanent all-wheel drive Hydrostat variable, forward: 0 – 6.7 km/h reverse: 0 – 6.5 km/h | central 50 – 105 mm, 5 x | 290 kg L 191 cm, W 98 cm, H 152 cm | G06900001 |
| AS 920 Sherpa 2WD | 90 cm | B&S 4-stroke 2-cylinder Professional Series 8, 724 ccm | 16,5 kW (22,4 hp) at 3.300 min ⁻¹ | 20,1 kW (27 hp) at 3.600 min ⁻¹ | 2-wheel drive Hydrostat variable, forward: 0 – 10,5 km/h reverse: 0 – 8,2 km/h | central 50 – 105 mm, 5 x | 280 kg L 191 cm, W 98 cm, H 152 cm | G06900201 |

AS 940 SHERPA 4WD RC
THE FIRST RIDE-ON MOWER WITH REMOTE CONTROL

Mow difficult terrain safely. AS-Motor's commitment to technology and innovation is evidenced in the Sherpa RC (Remote Control) – the world's first rough-terrain ride-on mower with remote control. Whether in manual or remote-controlled operation, with the new AS 940 Sherpa 4WD RC you can mow slopes, high grass and rough-terrain safely and conveniently.

REMOTE CONTROL OPERATION AND
MANUAL OPERATION ARE POSSIBLE

Professional remote control unit with max. 300 m range, depending on the terrain situation.

Main functions:

- Adjustment of the cutting height
- Engine on / off function
- Blade on / off
- Steering via remote control unit
- Differential lock
- Maximum inclination transverse to the slope – remote controlled operation 33°
- Maximum inclination transverse to the slope – ride-on operation 20°
- Safety functions
 - Engine protection function at low oil pressure
 - Emergency stop on the machine
 - Warning signal at 33° angle transverse to the slope

Steep slope compatible
15 litre tank
for long range

Galvanised
steel front guard

Switchable differential lock
for maximum traction

Sturdy folding bar

High sitting comfort
thanks to the seat
suspension kit with
progressive suspension
and damping elements

2-cylinder B&S engine with
oil and fuel pump and oil
control

Switching lever for manual
or remote operation

XL tyres for
increased ground
clearance

All-round, tubular steel frame
with integrated lashing points

Reinforced surfing mower deck lifts
to avoid ground contact with the blades,
optional mulching kit available



MORE SAFETY

Safer work on pathless terrain,
on difficult to access passages
and steep slopes.



MORE CONVENIENCE

Convenient operation from a
safe distance, without expo-
sure to dust, noise or exhaust
fumes.



MORE EFFICIENCY

Easier working on slopes,
under trees and bushes,
along hedges, thorns and
scrub.



PROFESSIONAL REMOTE
CONTROL SYSTEM

Remote control with a range
up to max. 300 m and easy,
mechanical changeover to
ride-on mode.



SURFING MOWER DECK

The Sherpa mower deck is desig-
ned to follow uneven ground
and edges with a surfing vertical
movement providing additional
ground clearance and avoiding
ground contact with the blades.

TECHNICAL SPECIFICATIONS

| Model | Cutting width | Engine | Rated power | Maximum engine power | Wheel drive, speed | Cutting height adjustment | Weight, dimensions | Item number |
|-------|---------------|--------|-------------|----------------------|--------------------|---------------------------|--------------------|-------------|
|-------|---------------|--------|-------------|----------------------|--------------------|---------------------------|--------------------|-------------|

| | | | | | | | | |
|----------------------------|-------|---|---|---|--|--------------------------------------|---|-----------|
| AS 940 Sherpa 4WD RC | 90 cm | B&S 4-stroke 2-cylinder Professional Series 8, 724 ccm | 16,5 kW (22,4 hp) at 3.300 min ⁻¹ | 20,1 kW (27 hp) at 3.600 min ⁻¹ | Permanent all-wheel drive Hydrostat variable, forward: 0 – 6.7 km/h reverse: 0 – 6.5 km/h | central 80 – 135 mm, stufenlos | 325 kg L 191 cm, W 106 cm, H 156 cm | G06900401 |
|----------------------------|-------|---|---|---|--|--------------------------------------|---|-----------|

Accessories overview see page 73

For detailed information
visit the AS Sherpa RC microsite:



AS 1040 YAK 4WD XL, AS 1040 YAK 4WD, AS 1020 YAK 2WD
THE PROFESSIONAL RIDE-ON FLAIL-MOWER
STRONG, ROBUST, PERFORMS ON DIFFICULT TERRAIN

The AS 1040 YAK 4WD's newly developed 100 cm wide flail mowing unit is a superior alternative to the conventional rotary mowing unit. Flail mowers impress above all through high area output, robustness against foreign objects and an even distribution of the cut grass and brush. The product family around the AS 1040 YAK 4WD is growing. For maximum possible ground clearance and off-road capability have a look at the new AS 1040 YAK 4WD XL. For agile mowing in flat terrain the new AS 1020 YAK 2WD could be of interest. Professional users can now choose and decide according to their specific needs and requirements.

AS 1040 YAK 4WD XL **NEW**

With agricultural-tyre tread, wheel size XL
front: 4.80/4.00-8
rear: 20x10.00-8



Safety against stone throw: confirmed by DLG, DIN EN 13524:2014, test report 17.00687.

For detailed information visit the **AS YAK microsite:**



SAFETY FIRST
Stable folding bar, integrated safety switch in the driver seat and panic pedal for emergency stop, ensure maximum operator safety. Lashing eyes on the device enable safer transport.



COMFORTABLE TRACTION DRIVE
Variable hydrostatic drive with one-hand drive lever, cruise control and integrated parking brake for fatigue-free work.



OPTIMAL ERGONOMICS
Upright sitting position, perfect steering wheel placement and legroom for operators up to 2.0 m tall. Lateral deflectors protect the operator from dense growth and thorns. Bucket seat with newly developed seat suspension.



SURFING FLAIL MOWER DECK
The surfing mower deck adapts to rough and uneven terrain. Easy height adjustment through spring support.



EASY MAINTENANCE
Simple replacement of the flails and drive belt thanks to appropriate service cut-outs and openings. Fast access to all maintenance points.



ANTI PUNCTURE
Tubeless tyres with AS Tyre sealant "PlattfussStop." Reduces the downtime caused by punctures reliably. (By series all YAK models).

AS 1040 YAK 4WD

With ATV-tyre tread, wheel size standard
front: 15x5.00-6, rear: 18x9.50-8

Watch our videos on



AS 1020 YAK 2WD **NEW**

With ATV-tyre tread, wheel size standard
front: 15x5.00-6, rear: 18x9.50-8



TECHNICAL SPECIFICATIONS

| Model | Cutting width | Engine | Rated power | Maximum engine power | Wheel drive, speed | Cutting height adjustment | Weight, dimensions | Item number |
|--------------------|---------------|---|--|--|---|-----------------------------|---|-------------|
| AS 1040 YAK 4WD XL | 100 cm | B&S 4-stroke 2-cylinder Vanguard V-Twin 3864, 627 ccm | 15,5 kW (21,1 hp) at 3.600 min ⁻¹ | 17,2 kW (23 hp) at 3.600 min ⁻¹ | Permanent all-wheel drive Hydrostat variable forward: 0 – 7,3 km/h reverse: 0 – 6,8 km/h | central 30 – 110 mm, 7 x | 351 kg L 199 cm, W 122 cm, H 162 cm (111 cm) | G90400103 |
| AS 1040 YAK 4WD | 100 cm | B&S 4-stroke 2-cylinder Vanguard V-Twin 3864, 627 ccm | 15,5 kW (21,1 hp) at 3.600 min ⁻¹ | 17,2 kW (23 hp) at 3.600 min ⁻¹ | Permanent all-wheel drive Hydrostat variable forward: 0 – 6,8 km/h reverse: 0 – 6,3 km/h | central 30 – 110 mm, 7 x | 335 kg L 199 cm, W 122 cm, H 159 cm (108 cm) | G90400101 |
| AS 1020 YAK 2WD | 100 cm | B&S 4-stroke 2-cylinder Vanguard V-Twin 3864, 627 ccm | 15,5 kW (21,1 hp) at 3.600 min ⁻¹ | 17,2 kW (23 hp) at 3.600 min ⁻¹ | 2-wheel drive Hydrostat stufenlos forward: 0 – 6,8 km/h reverse: 0 – 6,3 km/h | central 30 – 110 mm, 7 x | 323 kg L 199 cm, W 122 cm, H 159 cm (108 cm) | G90400201 |

Accessories overview see page 73

AS WEED REMOVERS



WEED REMOVAL WITHOUT CHEMICALS

Unfortunately weeds are always in season: kerb stones, car parks or athletic facilities must be freed of the undesired growth several times per year.

This affects both municipalities and private persons. Use of plant protection agents, such as glyphosate, is strictly regulated and only permitted on certain areas for good reason. Actually, it is not even necessary: an environmentally-friendly alternative to the chemical assault is pure mechanical elimination of weeds with our weed removers.

The AS 50 WeedHex and AS 30 WeedHex eliminates the need for plant protection agents, removing weeds and uncontrolled growth with the patented oscillating brush system, even where heavy equipment cannot be used. The weed removers clean perfectly along kerb stone edges and walls, and remove weeds from joints and between stones. With the same efficiency, the devices ensure cleanliness on car parks and terraces with grass pavers and paving stones. They even reliably clean hard courts.

The work speed can be adapted to the soil or ground conditions. Due to their pure mechanical mode of operation, the AS 50 WeedHex and the AS 30 WeedHex can be used anywhere, even in environmentally-sensitive areas.

New: AS 30 E-WeedHex 82V with Lithium-battery, ideal for use in noise sensitive areas. Quiet, low-vibration and without exhaust fumes.

The ideal supplement for all professional users: the AS 50 WeedHex for larger areas, and the AS 30 WeedHex for uneven coverings, such as cobblestones and on walls and kerb stones.

| | AS 30 WeedHex140 | AS 30 WeedHex160 | AS 30 E-WeedHex | AS 50 WeedHex |
|----------------------|--|--|--|---|
| Working width | 35 cm (42 cm)* | 35 cm (42 cm)* | 35 cm (42 cm)* | 50 cm |
| Wheel drive | — | — | — | 2-wheel drive, variomatic |
| Brush type, series | — | — | — | 2 braid brushes, steel |
| Brush type, optional | Plate brush, steel Ø 35 cm Plate brush, nylon, Ø 35 cm or * brush holder for braid brushes, steel, Ø 42 cm | Plate brush, steel Ø 35 cm Plate brush, nylon, Ø 35 cm or * brush holder for braid brushes, steel, Ø 42 cm | Plate brush, steel Ø 35 cm Plate brush, nylon, Ø 35 cm or * brush holder for braid brushes, steel, Ø 42 cm | — |
| Particularities | OHV engine, 140 ccm | B&S-engine, 175 ccm, snorkel filter | B&S 82 V Battery drive | Double stone throw protection, snorkel filter, collecting bag |
| Kerb stones | ● | ● | ● | ● |
| Concrete pavements | ● | ● | ● | ● |
| Lawn-grid pavement | ● | ● | ● | ● |
| Asphalted surfaces | ● | ● | ● | ● |
| Unpaved surfaces | ● | ● | — | — |
| Uneven surfaces | ● | ● | ● | — |
| Alongside walls | ● | ● | ● | ● |
| Compressed snow | ● (with plate brush steel) | ● (with plate brush steel) | — | — |

● good ● limited — not recommended

AS 50 WeedHex

Reduction of scraping on surfaces and minimising manual labour – the AS 50 WeedHex efficiently removes weeds from joints between cobble stones.

Wherever you work, the double stone guard provides maximized security, while minimising noise exposure.

Due to the purely mechanical brush system, the WeedHex can also be used in environmentally sensitive areas. Through adjustable working speed, the cleaning of kerbs or driving along walls of buildings is not a problem.

By using the collecting bag, no subsequent sweeping is required.



Watch our videos on YouTube



TECHNICAL SPECIFICATIONS

Accessories overview see page 71

| Model | Working width | Engine | Rated power | Maximum engine power | Wheel drive, speed | Weight, dimensions | Item number |
|---------------|---------------|--|--|--|--|-------------------------------------|-------------|
| AS 50 WeedHex | 50 cm | B&S 4-stroke, 850E-Series I/C, 190 ccm | 3,2 kW (4,3 hp) at 2.800 min ⁻¹ | 4,1 kW (5,5 hp) at 3.600 min ⁻¹ | Variomatic variable, 1,6 – 2,5 km/h Rear-Wheel drive | 68 kg L 192 cm, W 61 cm, H 99 cm | G07300104 |



OPERATION
The patented pendulum brush system adjusts to the surface. The centrifugal force regulates the pressure of the brush.



STONE GUARD
The double stone guard protects against stone impact.



DRIVE
Rear wheel drive with variable speed (variomatic). Swivel front wheel for easy steering around obstacles.



COLLECTING BAG
Weeds, wild growth, sand and small stones are immediately caught by the bag. No annoying sweeping necessary.



RANGE OF APPLICATION 1: KERB SIDE CLEANING
Perfect cleaning of kerb sides by working close to edge or along walls.



RANGE OF APPLICATION 2: PAVEMENTS
Perfect for cleaning all kinds of even pavements.



RANGE OF APPLICATION 3: LAWN-GRID PAVEMENTS
Removes weeds without taking out soil from the grid-stones.

AS 30 WeedHex

The AS 30 WeedHex is the ideal supplement to the AS 50 WeedHex for effective cleaning of uneven coverings, at narrow points, walls and kerb stones.

The reduced brush speed of only 600 rpm and the protective cloth enable safe work with minimal risk of stone impact and dust development.

Through motor brushing support the torque increases by more than double. Result: clear more power on the brush, even stubborn weeds have no chance.

The wheels can be individually adjusted in height, which ensures an incline of the brush; through this measure weed removal is possible even in lower edge areas.

AS 30 WEEDHEX 160



AS 30 WeedHex 140



OPERATION
Effective cleaning, even on inaccessible areas, difficult kerbs, grooves and edges.



WINTER SERVICES
Easily removes compressed snow and ice on bus stops, entrances and platform edges. (AS 30 WeedHex 140/160).



RANGE OF APPLICATION
Even or uneven pavements, kerbs, gravel roads, mossy surfaces, compressed snow, etc.



LIGHTWEIGHT
With only 35-37 kg of weight and a foldable handlebar the AS 30 is manouverable and easy to transport.

TECHNICAL SPECIFICATIONS

Accessories overview see page 71

| Model | Working width | Engine | Rated power | Maximum engine power | Weight, dimensions | Item number |
|---------------------------------|--|---------------------------------------|--|--|---|-------------|
| AS 30 WeedHex 140 without brush | 35 cm, standard brush (42 cm with optional braid-brush holder) | 4-stroke OHV, 140 ccm | 1,8 kW (2,5 hp) at 2.800 min ⁻¹ | 2,4 kW (3,3 hp) at 3.600 min ⁻¹ | 35 kg L 160 cm, W 62 cm, H 108 -120 cm | G07300109 |
| AS 30 WeedHex 160 without brush | 35 cm, standard brush (42 cm with optional braid-brush holder) | B&S 4-stroke, 800 EXi-Series, 175 ccm | 2,9 kW (3,9 hp) at 2.800 min ⁻¹ | 3,8 kW (5,1 hp) at 3.600 min ⁻¹ | 40 kg L 160 cm, W 62 cm, H 108 -120 cm | G07300110 |

AS 30 E-WeedHex

Full power, low emission. The new AS 30 E-WeedHex is powered by a lithium-ion battery that matches the performance of an internal combustion engine. It does the same job, just quieter, cleaner and with less vibration.

Ideal for service providers in noise-sensitive areas such as residential complexes, hospitals, nursing homes, day-care centers and office buildings.

Battery life: 30 to 45 minutes, depending on the brush type and application area.



Battery and charger not included!



CHOOSE THE RIGHT BRUSH AND ACCESSORIES:



BRUSH HOLDER FOR BRAID BRUSHES
Quick change system, uses the same braid brushes as AS 50 WeedHex. Can be used with three, four or six braid brushes. Brushing power: high.



PLATE BRUSH, STEEL
Brush for AS 30 WeedHex, Ø 35 cm. Brushing power: very high.



PLATE BRUSH, NYLON
Nylon plate brush for sensitive surfaces. (e.g. clinker bricks, natural stone, wood planks, terracotta, etc.) brushing power: gentle



NEW STABILISER WHEEL
Lockable guide wheel, reduces lateral forces and allows a constant contact pressure. Optional for all AS 30 WeedHex, see accessories.

TECHNICAL SPECIFICATIONS

Accessories overview see page 71

| Model | Working width | Engine | Rated Voltage | Max. Voltage | Weight, dimensions | Item number |
|--|---|--|---------------|--------------|--|-------------|
| AS 30 E-WeedHex without brush, battery and charger | 35 cm with plate brush 42 cm with braid-brush holder | B&S 82Li Series 82V Lithium Ion Powerhead | 72 Volt | 82 Volt | (with plate brush) 35 kg L 157 cm, W 61 cm, H 108 -120 cm | G07300111 |
| B&S Li-ion battery | | 5,0 Ah | 72 Volt | 82 Volt | 2,5 kg | G07300106 |
| B&S Charger | | 4A | | 82 Volt | 1,5 kg | G07300107 |

| MULCHING MOWERS | | | | | | | | | |
|--|----------------------|---------------------|----------------------|-----------------------|------------------------|---|--------------------------------|-------------------------------|---|
| AS ACCESSORIES | AS 420 ProClip 4T | AS 420 E-ProClip | AS 470 ProClip 4T | AS 470 E-ProClip A | AS 510 ProClip 4T A | AS 510 ProClip 2T A ES | AS 510 ProClip 4T A 2in1 | AS 510 E-ProClip A 2in1 | AS 510 ProClip 2T ES A 2in1 |
| Operating hour meter (order by spare parts) | G06927019 | | G06927019 | | G06927019 | G06927019 | G06927019 | | G06927019 |
| Inclinometer (order by spare parts) | G06950027 | G06950027 | G06950027 | G06950027 | G06950027 | G06950027 | G06950027 | G06950027 | G06950027 |
| Front and side protection | | | | | G51080002 | G51080002 | G51080002 | G51080002 | G51080002 |
| 5-litre fuel tank | | | | | G51080001 | in series | G51080001 | | in series |
| AS 2-stroke-oil „Titan 2T“ for mixture 1:100 (recommended for all AS 2-stroke engines) | | | | | | 100 ml G00041056 1 liter G00041042 40 x 100 ml G00041058 | | | 100 ml G00041056 1 liter G00041042 40 x 100 ml G00041058 |
| B&S Li-io battery 82V, 5,0 Ah | | G07300106 | | G07300106 | | | | G07300106 | |
| B&S Charger for Li-ion battery 82V, 4A | | G07300107 | | G07300107 | | | | G07300107 | |

| PROFESSIONAL LAWN MOWERS | | | | | |
|--|--|--|-----------------|-------------------|--|
| AS ACCESSORIES | AS 53 2T ES 4WD | AS 53 2T ES 4WD RB | AS 531 4T MK | AS 531 4T MK B | AS 531 2T ES MK B |
| Twin wheels (Set for one axis) | G06321009 | G06321009 | | | |
| Collecting bag for side discharge | G04324000 | G04324000 | | | |
| Operating hour meter (order by spare parts) | G06927019 | G06927019 | G06927019 | G06927019 | G06927019 |
| Rear axle brake (lockable) | G04334001 | Serie | | | |
| Hand guard set (plastic) | G06380070 | G06380070 | | | |
| Inclinometer (order by spare parts) | G06950027 | G06950027 | G06950027 | G06950027 | G06950027 |
| Mulching kit (max. grass height 20 cm) | G04323005 | G04323005 | in series | in series | in series |
| 2-stroke-oil „Titan 2T“ for mixture 1:100 (recommended for all AS 2-stroke engines) | 100 ml G00041056 1 Liter G00041042 40 x 100 ml G00041058 | 100 ml G00041056 1 Liter G00041042 40 x 100 ml G00041058 | | | 100 ml G00041056 1 Liter G00041042 40 x 100 ml G00041058 |

Accessories for older devices and spare parts for accessories are available via your AS-Motor dealer and www.parts-and-more.org

| ALLMÄHER® | | | | | |
|--|-----------------|------------------|--|--|--|
| AS ACCESSORIES | AS 21 4T B&S | AS 21 4T Comfort | AS 21 2T ES | AS 26 2T ES | AS 28 2T ES |
| Twin wheels | not recommended | not recommended | G06321009 | G06321009 | |
| Climbing aid | not recommended | not recommended | G06321029 | G06321029 | |
| Tubeless wheels (order by spare parts) | | | | | Right: G06921018 Left: G06921017 |
| Operating hour meter (order by spare parts) | G06927019 | G06927019 | G06927019 | G06927019 | G06927019 |
| Rear axle brake (lockable) | G06334027 | G06334027 | G06334027 | G06334027 | in series |
| Hand guard set (plastic) | G06380070 | G06380070 | G06380070 | G06380070 | G06380070 |
| Inclinometer (order by spare parts) | G06950027 | G06950027 | G06950027 | G06950027 | G06950027 |
| Special blade for sandy areas (order by spare parts) | G06023005 | G06023005 | G06023005 | G06323003 | G06323003 |
| 2-stroke-oil „Titan 2T“ for mixture 1:100 (recommended for all AS 2-stroke engines) | | | 100 ml G00041056 1 liter G00041042 40 x 100 ml G00041058 | 100 ml G00041056 1 liter G00041042 40 x 100 ml G00041058 | 100 ml G00041056 1 liter G00041042 40 x 100 ml G00041058 |
| Tyre sealant „Plattfuss-Stop“ 950 ml bottle | | | | | G00041068 (sufficient for both tyres) |
| Tyre sealant „Plattfuss-Stop“ 20 liters bucket <small>See filling quantities: as-motor.com/product/liquide-tyre-sealant</small> | | | | | G00041069 |
| Pump for 20 liters bucket Tyre sealant „Plattfuss-Stop“ | | | | | G00041070 |

Accessories for older devices and spare parts for accessories are available via your AS-Motor dealer and www.parts-and-more.org

| | ALLMÄHER® | | | | | |
|--|--------------|--|--|--|---|---|
| AS ACCESSORIES | AS 62 4T B&S | AS 63 4T Honda / B&S | AS 63 2T ES | AS 65 2T ES | AS 65 4T B&S | AS 73 4T B&S |
| Branch deflector | | | | G06726021 | G06726021 | G06726021 |
| Twin wheels tubular (two complete wheels) | | G60021011 (not recommended for AS 63 4T Honda) | G60021011 | G06521000 | G06521000 | G06521000 (2 sets obligatory) |
| Operating hour meter (order by spare parts) | G06927019 | G06927019 | G06927019 | G06927019 | G06927019 | G06927019 |
| Hand guard set (steel) | | | | G06780309 | G06780309 | G06780309 |
| Inclinometer (order by spare parts) | G06950027 | G06950027 | G06950027 | G06950027 | G06950027 | G06950027 |
| Electric starter | | | | | G06727305 (from serial number 021313050001) | G06727305 (from serial number 014613050001) |
| Steel wheels with wheel hub (kit) | | | | G06780016 | G06780016 | |
| Tubeless wheel (order by spare parts) | | | | Right: G06921018 Left: G06921017 | Right: G06921018 Left: G06921017 | |
| Low pressure tyres (two complete wheels) | | | | G06721006 | G06721006 | in series |
| Grip heating | | | | | G06722040 | G06722040 |
| Snorkel filter (including filter housing / stage V engines) | | | G60005003 (from serial number 034619070001) | G06705002 (from serial number 035219010001) | | |
| Mulching kit | G60026026 | G60026026 | G60026026 | | | |
| 2-stroke-oil „Titan 2T“ for mixture 1:100 (recommended for all AS 2-stroke engines) | | | 100 ml G00041056 1 Liter G00041042 40x100 ml G00041058 | 100 ml G00041056 1 Liter G00041042 40x100 ml G00041058 | | |
| Tyre sealant „Plattfuss-Stop“ 950 ml bottle | | G00041068 (sufficient for both tyres) | G00041068 (sufficient for both tyres) | G00041068 (sufficient for both tyres) | G00041068 (sufficient for both tyres) | G00041068 (sufficient for both tyres) |
| Tyre sealant „Plattfuss-Stop“ 20 liters bucket <small>See filling quantities: as-motor.com/product/liquide-tyre-sealant</small> | | G00041069 | G00041069 | G00041069 | G00041069 | G00041069 |
| Pump for 20 liters bucket Tyre sealant „Plattfuss-Stop“ | | G00041070 | G00041070 | G00041070 | G00041070 | G00041070 |

Accessories for older devices and spare parts for accessories are available via your AS-Motor dealer and www.parts-and-more.org

| | FLAIL MOWERS | | ROTARY MOWERS | | WEED REMOVERS | | |
|--|---------------------------------------|-------------------------------------|---------------------------------------|---------------------------------------|------------------------------|---|--|
| AS ACCESSORIES | AS 701 SM | AS 901 SM | AS 585 KM | AS 625 KM | AS 50 WeedHex | AS 30 WeedHex 140/160 | AS 30 E-WeedHex |
| Twin wheels | G06521000 (exceeds cutting width) | in series | | | | | |
| Low pressure tyres | G06721006 (replaces original tyres) | | | | | | |
| Tubeless wheel (order by spare parts) | Right: G06921018 Left: G06921017 | Right: G06921018 Left: G06921017 | | | | | |
| Operating hour meter (order by spare parts) | in series | in series | G06927019 | G06927019 | G06927019 | G06927019 | |
| Hand guard set (steel) | G06780309 | G06780309 | | | | | |
| Inclinometer (order by spare parts) | G06950027 | G06950027 | G06950027 | G06950027 | | | |
| Steel wheels with wheel hub | G06780016 (exceeds cutting width) | G06780016 (replaces outside wheels) | | | | | |
| Grip heating | G06722040 | | | | | | |
| Stabiliser wheel | | | | | | G07399001 AS 30 140 from serial-no. 028719080001 AS 30 160 from serial-no. 02991904001 | G07399001 AS 30 E-WeedHex from serial-no. 033219030001 |
| Brush holder Ø 42 cm (without braid brushes) | | | | | | G07381001 | G07381001 |
| Braid brush steel minimum order qty. 10 pcs. (order by spare parts) | | | | | G07323015 (2 pcs. necessary) | G07323015 (3, 4 or 6 pcs. necessary for brush holder) | G07323015 (3, 4 or 6 pcs. necessary for brush holder) |
| Plate brush steel Ø 35 cm | | | | | | G07323029 | G07323029 |
| Plate brush nylon Ø 35 cm for sensitive surfaces | | | | | | G07352038 | G07352038 |
| B&S Li-ion battery 82V, 5,0 Ah | | | | | | | G07300106 |
| B&S Charger for Li-ion battery 82V, 4A | | | | | | | G07300107 |
| Tyre sealant „Plattfuss-Stop“ 950 ml bottle | G00041068 (sufficient for both tyres) | G00041068 (sufficient for 2 tyres) | G00041068 (sufficient for both tyres) | G00041068 (sufficient for both tyres) | | | |
| Tyre sealant „Plattfuss-Stop“ 20 liters bucket <small>See filling quantities: as-motor.com/product/liquide-tyre-sealant</small> | G00041069 | G00041069 | G00041069 | G00041069 | | | |
| Pump for 20 liters bucket Tyre sealant „Plattfuss-Stop“ | G00041070 | G00041070 | G00041070 | G00041070 | | | |

Accessories for older devices and spare parts for accessories are available via your AS-Motor dealer and www.parts-and-more.org

| IMPLEMENT CARRIER | | RIDE-ON ALLMÄHER | | |
|---|-----------------|--|--|--|
| AS ACCESSORIES | AS 600 MultiPro | AS 799 Rider | AS 800 FreeRider | AS 900 Enduro from serial-no. 0335 18 XX 0001 |
| Trailer without hitch, gross load weight 100 kg | | G06800003 | G06800003 | G06800003 |
| Trailer hitch | | G06800004 | G06800004 | G06600005 |
| Snow blade without adapters | | G06837006 | G06837006 | G06837006 |
| Adapter and operating elements for snow blade | | G06837017 | G06837017 | G06637011 (from serial-no. 0335 18 XX 0001) |
| Snow chains rear | | G06837015 | G06837015 | G06637013 |
| Seat suspension kit | | G06800103 (from serial-no. 0301 17 10 0001) | G06800103 (from serial-no. 0300 17 10 0001) | G06600103 (from serial-no. 0335 18 XX 0001) |
| Lawn tyres front (two tyres without rim) | | G06621001 | G06621001 | |
| Lawn tyres rear (two tyres without rim) | | G06821007 | G06821007 | |
| Twin wheels kit | G90999101 | | | |
| Operating hour meter (order by spareparts) | in series | G06927019 | G06927019 | in series |
| Inclinometer (order by spareparts) | G06950027 | G06950027 | G06950027 | G06950027 |
| Steering wheel knob | | G06980011 (from serial-no. 0301 17 10 0001) | G06980011 (from serial-no. 0300 17 10 0001) | G06980011 (from serial-no. 0335 18 XX 0001) |
| Tyre sealant „Plattfuss-Stop“ 950 ml bottle | G00041068 | G00041068 (sufficient for 2 front- or 1 rear tyre) | G00041068 (sufficient for 2 front- or 1 rear tyre) | G00041068 (sufficient for 2 front- or 1 rear tyre) |
| Tyre sealant „Plattfuss-Stop“ 20 liters bucket <small>See filling quantities: as-motor.com/product/liquide-tyre-sealant</small> | G00041069 | G00041069 | G00041069 | G00041069 |
| Pump for 20 liters bucket Tyre sealant „Plattfuss-Stop“ | G00041070 | G00041070 | G00041070 | G00041070 |

Accessories for older devices and spare parts for accessories are available via your AS-Motor dealer and www.parts-and-more.org

| RIDE-ON ALLMÄHER | | | | | | | | |
|---|--|--|--|--|--|----------------------|---------------------|-----------------------|
| AS ACCESSORIES | AS 915 Sherpa 2WD | AS 920 Sherpa 2WD | AS 940 Sherpa 4WD | AS 940 Sherpa 4WD XL | AS 940 Sherpa 4WD RC | AS 1020 YAK 2WD | AS 1040 YAK 4WD | AS 1040 YAK 4WD XL |
| Trailer (without hitch, gross load weight 100 kg) | G06800003 | G06800003 | G06800003 | G06800003 | G06800003 | G06800003 | G06800003 | G06800003 |
| Trailer hitch | G06900002 | G06900002 | G06900002 | G06900002 | G06900002 | G90400102 | G90400102 | G90400102 |
| Operating hour meter (order by spareparts) | G06927019 | in series | in series | in series | in series | in series | in series | in series |
| Snow blade without adapters | G06837006 | G06837006 | G06837006 | G06837006 | G06837006 | not recom- mended | G06837006 | |
| Adapter and operating elements for snow blade | G06937014 | G06937014 | G06937014 | G06937014 | G06937014 | not recom- mended | G90499002 | |
| Snow chains front | | | G06937005 | | | | | |
| Snow chains rear | G06937003 | G06937003 | G06937003 | | | | | |
| Seat suspension kit | G06900204 | in series | in series | in series | in series | in series | in series | in series |
| Twin wheels rear extreme traction | G06921016 | G06921016 | G06921016 | | | | | |
| Standard wheel kit AS 940 4WD (Set front / rear) | | | | G06999001 | G06999001 | | | |
| XL wheel kit AS 940 (Set front/rear) | | | G06921014 | in series | in series | | | |
| Tubeless front wheel (order by spareparts) | | | | Right: G06921018 Left: G06921017 | in series | | | in series |
| Grass-winding protection kit front axle | | | G06999004 | G06999003 | G06999003 | | in series | G06999003 |
| Mulching kit (max. grass height 50 cm) | G06926034 | G06926034 | G06926034 | G06926034 | G06926034 | | | |
| Inclinometer (order by spareparts) | G06950027 | G06950027 | G06950027 | G06950027 | in series | G06950027 | G06950027 | G06950027 |
| Steering wheel knob Read safety instructions. Not recommended in uneven terrain. | G06980011 | G06980011 | G06980011 | G06980011 | G06980011 | G06980011 | G06980011 | G06980011 |
| Blade spacer replaces upper mulching blade | G06950065 | G06950065 | G06950065 | G06950065 | G06950065 | | | |
| LED headlights 2 pieces, with mount, switch and cable | | G06999002 | G06999002 | G06999002 | not recommended | | | |
| Tyre sealant „Plattfuss-Stop“ 950 ml bottle | G00041068 (sufficient for 2 front- or 1 rear tyre) | G00041068 (sufficient for 2 front- or 1 rear tyre) | G00041068 (sufficient for 2 front- or 1 rear tyre) | G00041068 (sufficient for 2 front- or 1 rear tyre) | G00041068 (sufficient for 2 front- or 1 rear tyre) | filled by series | filled by series | filled by series |
| Tyre sealant „Plattfuss-Stop“ 20 liters bucket <small>See filling quantities: as-motor.com/product/liquide-tyre-sealant</small> | G00041069 | G00041069 | G00041069 | G00041069 | G00041069 | G00041069 | G00041069 | G00041069 |
| Pump for 20 liters bucket Tyre sealant „Plattfuss-Stop“ | G00041070 | G00041070 | G00041070 | G00041070 | G00041070 | G00041070 | G00041070 | G00041070 |

Accessories for older devices and spare parts for accessories are available via your AS-Motor dealer and www.parts-and-more.org



TWIN WHEELS

Available for AS 21, AS 26, AS 53, for improved traction. (complete kit).



CLIMBING AID

For AS 21 2T ES and AS 26 2T ES. Improves traction even during work transverse to the slope. (complete kit).



TRAILER

For ride-on mowers. Load floor: L = 1071mm, W = 607 mm, loading sill height = 274 mm. Maximum gross weight: 100 kg. Rear flap removable.



TRAILER HITCH AS SHERPA / AS YAK

For connecting the AS trailer with all Sherpa and YAK. Max. tensile load: 100 kg, max. drawbar load: 25 kg.



TWIN WHEELS

Available for AS 63, ideal for AS 63 2T ES when used on slopes. (complete kit).



LOW-PRESSURE WHEELS

Better traction on loose ground. Larger contact area preserves the soil. For AS 65 and 701 SM.



TRAILER HITCH AS 799 / AS 800

For connecting the AS trailer with the AS 799 Rider or AS 800 Freerider. Max. tensile load: 100 kg, max. drawbar load: 25 kg.



TRAILER HITCH AS 900

For connecting the AS trailer with the AS 900 Enduro. Max. tensile load: 100 kg, max. drawbar load: 25 kg.



TWIN WHEELS

One pair of tube wheels (1x2) with fixed hub for additional fitting on AS 65, AS 600 MultiPro, AS 701 SM.



TWIN WHEELS

One pair (2x2) of rear twin tyres with extreme tread pattern for highest traction. For AS Sherpa 915, 920, 940, not Sherpa 940 XL and RC. (complete kit).



5 LITER FUEL TANK

The 5 l fuel tank available for AS 510 4T, increases the range.



SIDE COLLECTING BAG

For AS 53 2T ES 4WD/RB.



STANDARD WHEEL KIT

For AS Sherpa 4WD XL and RC. Tubless ATV wheel kit as standard equipment. Low pressure. Perfect for the use of tyre sealant "Plattfuss-Stop". Size front: 15x5.00-6 rear: 18x9.50-8.



XL WHEEL KIT

For AS 940 Sherpa 4WD. Wheel kit with track extension for 30 mm more ground clearance. Size front: 4.80/4.00-8 rear: 20x10.00-8 (not for AS 915 and AS 920 Sherpa).



BRANCH DEFLECTOR

Careful mowing among trees and in plantations. Available for AS 65 and AS 73. Additional width in total: 11 cm.



FRONT AND SIDE PROTECTION

Protects front wheels and machine sides from impacts. For all AS 510, even 2in1 models.



TUBELESS WHEEL

For high puncture safety in additional use of tyre sealant "Plattfuss-Stop". For AS 28, AS 65, AS 701, AS 901, AS 940 Sherpa 4WD XL and AS 940 Sherpa 4WD RC.



LAWN TYRES

Low impact tread for use on the AS 799 and AS 800.



HAND PROTECTION

Effective protection against thorns and tendrils. For AS 53, AS 21, AS 26 and AS 28.



HANDGUARD SET, STEEL

For AS 65, AS 65 Scout, AS 73, AS 701, AS 901.



STEEL WHEELS

Improves traction even during work transverse to the slope. Steel wheel for AS 65, AS 701, and AS 901. Replaces outside wheels on AS 901 SM.



SNOW CHAINS

Snow chains for the rear drive axle on the AS 799/800/900 and all Sherpas except XL and RC.



REAR WHEEL BRAKE

Parking- and safety brake, for AS 21, AS 26, and AS 53 2T ES 4WD.



GRIP HEATING

For AS 65 4T B&S, AS 65 Scout, AS 73, AS 701.



STEERING KNOB

Facilitates one-handed steering and manoeuvring. Follow safety instructions.



INCLINOMETER

Always in sight. Simply attaches to the fuel tank of ride-on mowers.



OPERATING HOUR METER

Optional for all devices with combustion engine. Shows engine rpm and operating hours.



SNORKEL FILTER

For AS 63 2T ES and AS 65 2T ES when using the machines in dusty terrain. Incl. filter housing at stage V engines. Please note the serial number hints.



MULCHING KIT AS SHERPA

Improves the cutting pattern and ensures a more uniform grass placement at grass heights of up to max. 40 cm. Suitable for all AS Sherpa ride-on mowers.



MULCHING KIT AS 62 & AS 63

For closure of the rear discharge and a good mulching result. Improves the cutting pattern for grass heights up to max. 40 cm.



SAND BLADE

Special blade of hardened steel. Reduced wear on sandy ground. Suitable for AS 21 2T, AS 26, AS 28.



BLADE SPACER

Spacer for replacing the upper mulching blade on all Sherpas. Advantageous in fibrous vegetation or for higher mowing speed in dense vegetation.



SEAT SUSPENSION KIT AS 915 SHERPA 2WD

Seat suspension with improved progressive suspension, reinforced gas pressure damper and new end stop. Adjustable from 60 -120 kg. Retrofit kit for AS 915 Sherpa 2WD.



SEAT SUSPENSION KIT AS 799, 800, 900

Seat suspension with improved progressive suspension, reinforced gas pressure damper and new end stop. Adjustable from 60 -120 kg. For AS 799 and AS 800 and 900.



B&S LI-ION BATTERY

Powerful B&S 82V lithium-ion battery for consistent performance. With integrated charge status indicator. 5.0 Ah.



B&S BATTERY CHARGER

Suitable charger for all B&S 82 V lithium-ion batteries. 4A.



BRAID BRUSH, STEEL

For AS 50 WeedHex and AS 30 in conjunction with the brush holder. AS 50: 2 pieces per machine, AS 30: 3, 4 or 6 pieces per machine.



PLATE BRUSH, STEEL

Brush for AS 30 WeedHex, Ø 35 cm. Brushing force: very high.



BRUSH HOLDER

For AS 30 WeedHex, allows the use of 3, 4 or 6 braid brushes. Working width 42 cm. Simple quick change system. Cutting force: high.



PLATE BRUSH, NYLON

For AS 30 WeedHex, designed for use on sensitive surfaces. Ø 35 cm. Brushing force: gentle.



TYRE SEALANT "PLATTFUSS-STOP" 950 ml

Seales promptly on and off punctures in all pneumatic tyres and stops creeping pressure loss. Reduces downtimes due to flat tyres.



TYRE SEALANT "PLATTFUSS-STOP" 20L

Seales promptly on and off punctures in all pneumatic tyres and stops creeping pressure loss. Reduces downtimes due to flat tyres.



PUMP FOR TYRE SEALANT "PLATTFUSS-STOP" 20L

High quality metering pump for tyre sealant bucket 20 l "Plattfuss-Stop".



AS 2-STROKE-OIL "TITAN 2T"

Enables an environmental gentle and optimal mixing ratio of 1: 100. Recommended for all AS 2-stroke engines.



ELECTRIC STARTER

For convenient starting. With ignition key. Can be retrofitted for AS 65 4T B&S, AS 73.



LED-HEADLIGHTS

Two high power 18W LED headlights, with mount, switch and cable. For all Sherpa models except AS 915 Sherpa 2WD and AS 940 Sherpa 4WD RC.



SNOW BLADE

For all AS-Motor ride-on-mowers. Adjustable on both sides. W: 1.107 mm. H: 348 mm.



GRASS-WINDING GUARD

Avoids tangling of long and thin grass in between wheel and front axle. For AS 940 Sherpa 4WD/XL/RC.



TRANSPORT BOX KIT

Compact transport box for installation behind the driver's seat suitable for all YAK models.



STABILISER WHEEL

Lockable guide wheel for all AS 30 WeedHex. Reduces lateral forces and allows a constant contact pressure.

AS-MOTOR WARRANTY

Our machines are designed to be extremely robust and durable, which is why we're happy to offer a manufacturer warranty that extends beyond your standard warranty.

Register your new AS-Motor mower here:

register.as-motor.de

to receive a warranty extension of 3 months from the purchase date.



AS-MOTOR SUSTAINABILITY

At AS-Motor, sustainability and environmental awareness are more than merely marginal topics that only affect packaging material and transport routes. At AS-Motor, real sustainability starts with that which is most essential – namely the product.

First and foremost, this is evident in the long service life of the machines, high value retention of used devices, long-term spare parts supply and the nationwide service network.



ADVICE, SALES AND SERVICE

The best way to see an AS-Motor machine in action is by visiting an authorised AS-Motor dealer. Your dealer will take the time to individually advise you regarding the purchase and servicing of the AS-Motor range of machinery to ensure your long term satisfaction. The AS-Motor dealer in your area, see: www.as-motor.com/service/dealer-search/

ALL TERRAIN MOWERS

MADE IN GERMANY

AS MOTOR

AS-Motor Germany GmbH & Co. KG

Ellwanger Straße 15
D-74424 Buehlertann
Germany

Phone +49 (0) 79 73 / 91 23-0

info@as-motor.de

www.as-motor.com

For further details of the performance capabilities of the AS-Motor models please visit our website at:

www.as-motor.com

View our application videos at:

www.youtube.com/ASMotorInternational

Your professional AS-Motor dealer:



fb.com/asmotorgermany



www.linkedin.com/company/as-motor/



Changes in technology, equipment and price are reserved. Of information or illustrations no claims can be derived. With publication of this catalog all previous catalogs invalid.